

# Teufel

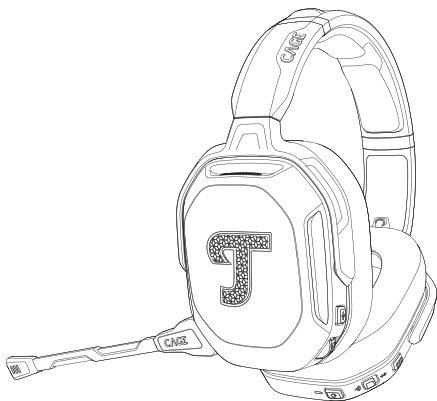

**CAGE®**  
**CAGE PRO**



[manuals.teufelaudio.com](https://manuals.teufelaudio.com)





## Lieferumfang

Scope of delivery / Contenu de la livraison /  
Volumen de suministro / Ambito di consegna /  
Leveringsomvang / Zakres dostawy

Kabelloser Gaming-Kopfhörer mit Li-Ionen-Batterie

Wireless gaming headphone with Li-Ion battery

Casque de jeu sans fil avec batterie Li-Ion

Auriculares para juegos inalámbricos con batería de iones de litio

Cuffie gaming wireless con batteria agli ioni di litio

Draadloze gaming-koptelefoon met Li-ion-batterij

Bezprzewodowe słuchawki gamingowe z baterią litowo-jonową

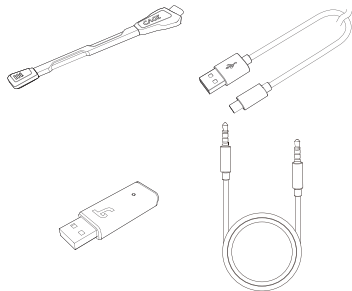



Montage  
Assembly / Montage /  
Montaggio / Montaje /  
Montage / Montaż

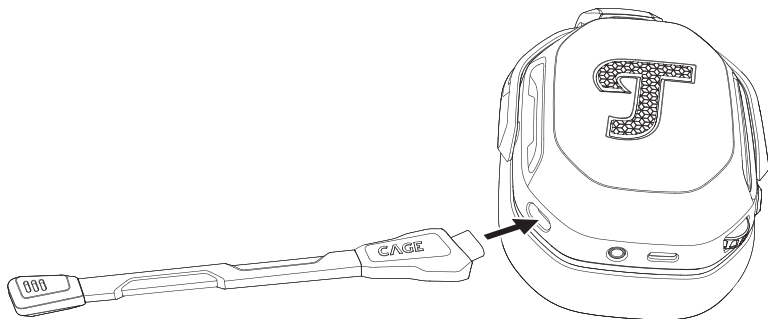



Gaming-Verbindung  
Gaming Connection / Connexion de jeu /  
Conexión para juegos / Connessione gaming /  
Gaming-verbinding / Połączenie do gier

## Teufel Audio Center for CAGE PRO



[manuals.teufelaudio.com](http://manuals.teufelaudio.com)

1

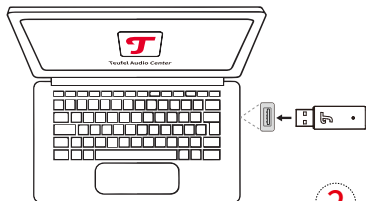

2

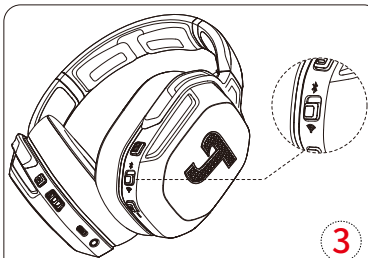

3

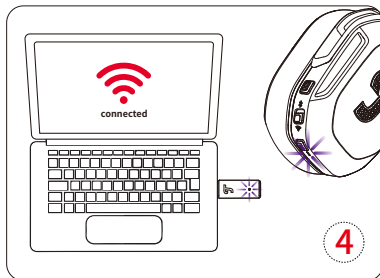

4



## Gaming-Funktion

Gaming Operation / Fonctionnement en jeu /

Funcionamiento para juegos / Funzionamento gaming /

Gaming-gebruik / Praca w trybie Gry

### Microphone Mute



### Headset Volume



### Multifunction Button

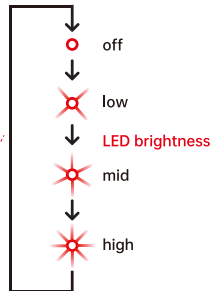

### Gaming/BT Switch



### On/Off

1.5 sec

Pairing

8 sec

Pairing

8 sec

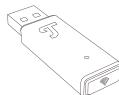



## Bluetooth® Verbindung

Bluetooth® connection / Connexion Bluetooth® /  
Conexión Bluetooth® / Collegamento Bluetooth® /  
Bluetooth® verbinding / Połączenie Bluetooth®

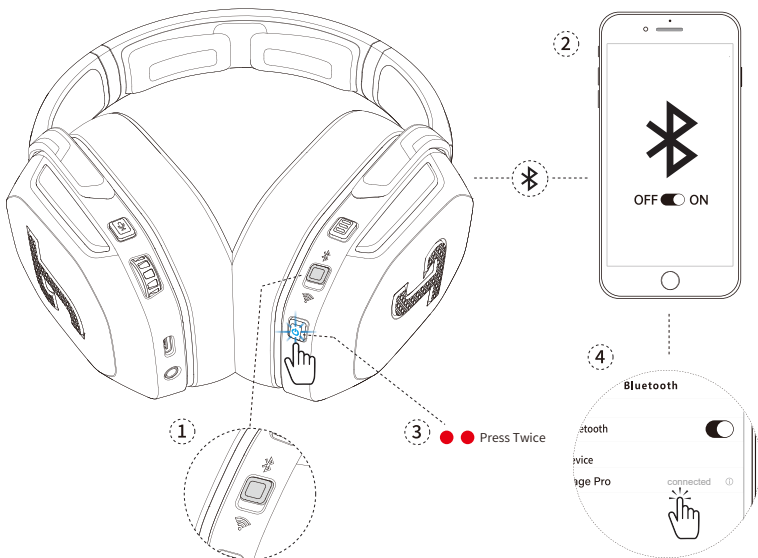



## Bluetooth-Funktion

Bluetooth Operation / Utilisation du Bluetooth /  
Funcionamiento para Bluetooth / Funzionamento Bluetooth  
Bluetooth-gebruik / Tryb Bluetooth

### Microphone Mute



### Headset Volume



### Multifunction Button



### Call Controls



### Gaming/BT Switch

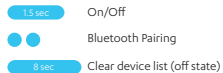



Aufladen  
Charging / Charge /  
Carga / Ricarica /  
Opladen / Ładowanie

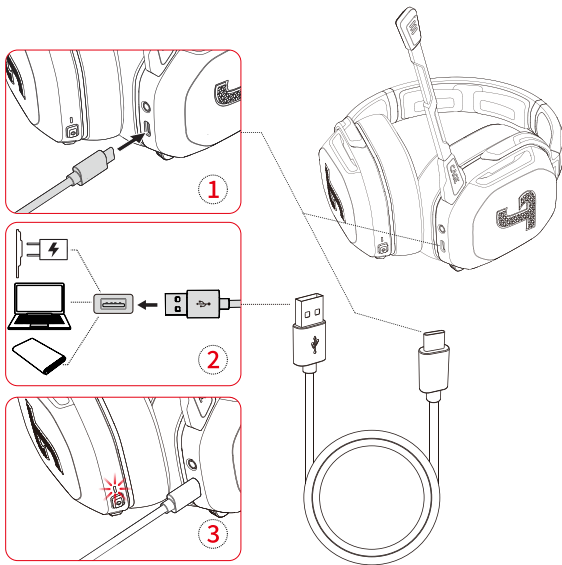





## Technische Daten

Technical data / Caractéristiques techniques /

Datos técnicos / Dati tecnici /

Technische gegevens / Dane techniczne

<b>Treibergröße</b> Driver Size / Taille de haut-parleur / Tamaño del controlador / Dimensioni del driver / Driver afmeting / Rozmiar przetwornika	Ø40 mm full range	
<b>Akku</b> Battery / Batterie / Batería / Batteria / Batterij / Bateria	Li-Po 3.7 V, 1000 mAh	
<b>Funknetz</b> Radio network / Réseau radio / Red de radio / Rete radio / Radionetwerk / Sieć radiowa	Bluetooth®	Wireless link
<b>Frequenzbänder in MHz</b> Frequency bands in MHz / Bandes de fréquences en MHz / Bandas de frecuencia en MHz / Bande di frequenza in MHz / Frequentiebanden in MHz / Pasma częstotliwości w MHz	2400 – 2483.5	2400 - 2483.5
<b>Übertragungsleistung in mW/dBm</b> Transmission power in mW/dBm / Puissance de transmission en mW/dBm / Potencia de transmisión en mW/dBm / Potenza di trasmissione in mW/dBm / Zendvermogen in mW/dBm / Moc transmisji w mW/dBm	9 mW / 9.54 dBm	8.28 mW / 9.18 dBm
<b>USB-Ladeleistung</b> USB Charging Power / Alimentation de charge USB / Alimentación de carga por USB / Potenza ricarica USB / USB-oplaadvermogen / Moc ładowania USB	5 V 1 A	

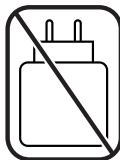

## Trademarks

© All trademarks and brand names are the property of their respective owners. Bluetooth® is a registered trademark of the Bluetooth SIG, Inc. Other trademarks and trade names are those of their respective owners.

For DTS patents, see <http://patents.dts.com>. Manufactured under license from DTS, Inc. or DTS Licensing Limited. DTS, DTS:X, DTS Sound Unbound, Headphone:X, the DTS logo, and the DTS:X logo are registered trademarks or trademarks of DTS, Inc. in the United States and other countries. © 2023 DTS, Inc. ALL RIGHTS RESERVED.

# Teufel

## Lautsprecher Teufel GmbH

Budapester Str. 44  
10787 Berlin  
Germany

[teufelaudio.com](http://teufelaudio.com)  
[teufel.de](http://teufel.de)  
[teufel.ch](http://teufel.ch)  
[teufelaudio.at](http://teufelaudio.at)  
[teufelaudio.nl](http://teufelaudio.nl)

[teufelaudio.be](http://teufelaudio.be)  
[teufelaudio.fr](http://teufelaudio.fr)  
[teufelaudio.pl](http://teufelaudio.pl)  
[teufelaudio.it](http://teufelaudio.it)  
[teufelaudio.es](http://teufelaudio.es)

## Telefon/Phone

Deutschland +49 (0)30 217 84 217  
Österreich +43 12 05 22 3  
Schweiz +41 43 50 84 08 3  
International 00800 200 300 40 (toll- free)

## Online-Support

[teufelaudio.com/support](http://teufelaudio.com/support)  
[teufel.de/support](http://teufel.de/support)

## Kontaktformular/ Contact

[teufel.de/kontakt](http://teufel.de/kontakt)  
[teufelaudio.com/contact](http://teufelaudio.com/contact)



Hereby, Lautsprecher Teufel GmbH declares that the radio equipment type CAGE PRO is in compliance with Directive 2014/53/EU. The full text of the EU declaration of conformity is available at the following internet address:

[teufel.de/konformitaetserklaerungen](http://teufel.de/konformitaetserklaerungen)  
[teufelaudio.com/declaration-of-conformity](http://teufelaudio.com/declaration-of-conformity)