

# Technical Description and User Manual

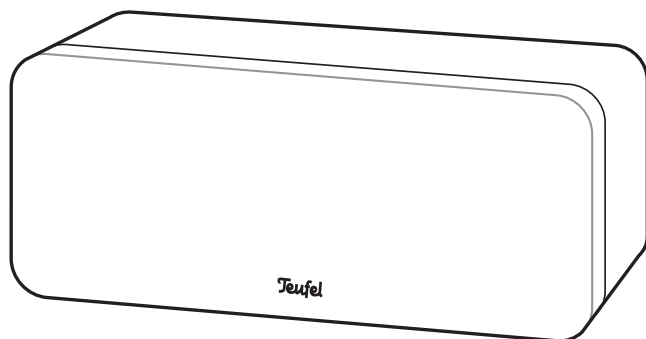

ULTIMA

## ULTIMA 40C MK3

Center speaker

# **Teufel**

# Contents

---

General Notes and Information .....	2
For Your Safety.....	3
Unpacking, Setup, Connection .....	6
Care and Cleaning.....	10
Technical Data .....	11
Declaration of Conformity .....	11
Disposal .....	12



Before operating the speaker, please first read the safety notes and user manual carefully. Only in this way, you can ensure that all functions are used in a safe and reliable manner. Store the user manual in a safe place and also be sure to pass it on to any subsequent owner.

## General Notes and Information

---

### Notice

The information in this document may change without prior notice and in no way constitutes any liability on the part of Lautsprecher Teufel GmbH.

No part of this user manual may be reproduced in any form or be broadcasted in any way electronically, mechanically, by photocopy or recording without the written permission of Lautsprecher Teufel GmbH.

© Lautsprecher Teufel GmbH  
Version 4.0, March 2022

### Original packaging

If you wish to exercise your right of return, we ask that you be absolutely sure to hold on to the packaging. We can only accept the return of the speakers WITH THE ORIGINAL PACKAGING.

Empty boxes are not available!

## Complaints

In case of a complaint we will need the following information to process your enquiry:

### 1. Invoice number

Can be found on the sales slip (enclosed with the product) or on the order confirmation received as a PDF document, e.g. 4322543

### 2. Serial number or batch number

Located on the back side of the device, e.g. serial no.: KB20240129A-123.

Thank you for your support!

## Contact

Please contact our customer service with any questions, suggestions or criticism:

**Lautsprecher Teufel GmbH**  
**BIKINI Berlin**  
**Budapester Str. 44**  
**10787 Berlin (Germany)**

Phone 00800 - 200 300 40 (toll-free)

Fax: +49 (0)30 / 300 930 930

Service:

[www.teufelaudio.com/service](http://www.teufelaudio.com/service)

Contact:

[www.teufelaudio.com/contact](http://www.teufelaudio.com/contact)

## For Your Safety

---

### Proper use

The center speaker is designed for the playback of audio signals that are transmitted by an external amplifier via a speaker cable.

Only use the speaker as described in this user manual. Any other use will be deemed as not in accordance with the instructions and may lead to damage of property or even persons.

The manufacturer accepts no liability for damage caused by improper use.

The center speaker is intended for private use only.

## Explanation of terms

You can find the following signal terms in this user manual:

### WARNING

***This signal term indicates a moderate risk, which, if not avoided, may result in death or severe injury.***

### CAUTION

***This signal term indicates a low risk, which, if not avoided, may result in minor or moderate injury.***

### NOTICE

***This signal term warns you of potential damage.***

## Safety notes

This chapter contains general safety notes which you should always observe to protect yourself and third parties. Also observe the warning notes in each chapter of this user manual.

### **An unsuitable setup location may result in injury and damage.**

- *If the speaker is not securely mounted, do not use it in vehicles, in unstable locations, on wobbly tripods or furniture, on under-dimensioned brackets etc. The speaker may fall down and cause injury to persons or be damaged itself.*
- *Place the speaker in such a way that it cannot be knocked down inadvertently and make sure that the cable does not pose a tripping hazard.*
- *Make sure that the wall mounting is done in a professional manner.*
- *In case of a wall mounting, verify the carrying capacity of the walls and make sure that there are no cables or pipes in the drilling areas. Before you drill, use a metal detector to check the applicable areas. Otherwise, there is a risk of electric shock/short circuit!*
- *Do not place the speaker near heat sources (e.g. heaters, ovens, other heat generating equipment such as amplifiers etc.).*

### **Children can become trapped in the plastic wrapping when playing and suffocate.**

- *Do not allow children to play with the device or the plastic wrapping. There is a danger of suffocation.*
- *Ensure that children do not remove small parts from the device or take them off of the device (e.g. control*

knobs or plug adapters). They could swallow the parts and choke.

### **Extended listening at high volumes may lead to hearing loss.**

To avoid damage to health, avoid extended listening at high volumes.

- When the volume is set high, always keep a certain distance and never hold your ears directly on the speaker.
- If an amplifier is set to full volume, this may produce very high sound pressure. This may have psychological consequences and also cause physical injury. Children and pets are particularly at risk. Set the volume control of your amplifier to a low setting before you turn it on.

### **This product contains magnetic material.**

- If necessary, consult your physician and ask for effects on implants such as pacemakers or defibrillators.

### **If the speaker is subjected to warm temperatures after being cold (e.g. after transport), condensation may occur inside of it.**

- In this case, wait at least 2 hours before you connect and activate the speaker.

### **Improper handling of the speaker may result in damage or fire.**

- Do not place open fire sources such as burning candles or similar on the speaker.
- Ensure sufficient ventilation.
- Do not expose the speaker to direct sunlight.

- Only use the speaker in indoor areas.
- Do not use the speaker in wet rooms and protect it against dripping or spraying water. Make sure that no vases or other liquid-filled objects are located on or near the device in order to prevent liquid from penetrating the housing.

### **The isolation pads can produce discolouration on sensitive surfaces.**

- On parquet, varnished wood and similar surfaces, you should stick felt gliders to the rubber feet of the speaker or put blankets or small carpets under it. This will prevent discolouration of the floor over the long term.

### **If the amplifier is underdimensioned, it may end up in clipping operation at high volumes, which could destroy the high-range speakers.**

- Only connect your speakers to amplifiers, which suit the output of your speakers.

### **An overdimensioned amplifier can destroy the bass speaker due to excessive volume.**

- If the music playback sounds distorted, reduce the volume.

# Unpacking, Setup, Connection

## Unpacking

- Carefully open the boxes, take out the EPE foam parts and carefully lift the speaker out of the box without touching the diaphragms.

**i** Due to differing customer requirements, the Ultima 40 series is shipped without any speaker cables. You can find suitable cables in our webshop ([www.teufelaudio.com](http://www.teufelaudio.com)) in the “Accessories” area.

### NOTICE

- Check that all items have been delivered and that nothing is damaged. If you find any damage, do not operate the device; instead contact our customer service department.

## Setup

**i** Our website contains comprehensive notes for correct setup.

### Location tips

- Select a stable, level base.
- Make sure that the environment is clean and free from dust.
- Select a location away from heat sources and direct sunlight.
- Lay the connector cord so that it does not pose a tripping hazard.
- Do not place any heavy objects on the cord or the speaker.

- Place the center speaker in a central position under or above the video screen or screen.
- It should be set up about 20 centimetres behind the front speakers.
- If you can only place the center speaker in line with the front speakers, you should activate the delay for the center channel (“Center Delay”) – providing that your AV receiver has this option. Many modern AV receivers and amplifiers do not offer this kind of function, but automatically set this delay to a correct value when looking up the distances from the listening position to the speakers of the Dolby Surround system in the installation menu.

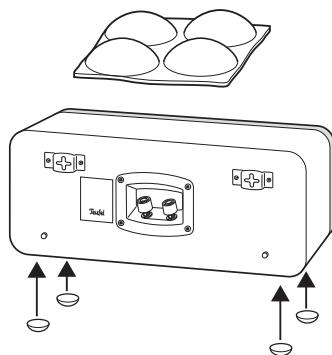

If you would like to set the speaker up, attach the 4 enclosed rubber feet to the corners of the speaker base. As a result, interference due to vibrations is avoided.

## NOTICE

**The isolation pads can produce discolouration on sensitive surfaces.**

- On parquet, varnished wood and similar surfaces, you should stick felt gliders to the rubber feet of the speaker or put blankets or small carpets under it. This will prevent discolouration of the floor over the long term.

## Wall mounting

### CAUTION

**Improper mounting may cause damage.**

- Make sure that wall mounting is done in a professional manner.
- Before drilling the holes, use a metal detector to ensure that there are no electrical cables or pipes in the wall within the drilling area.
- Use only suitable screws and dowels for fixing. Verify the carrying capacity of the walls.

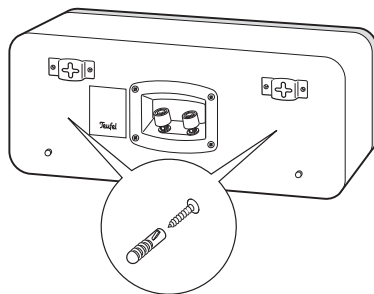

- Hang the center speaker on the wall using the keyhole openings and the previously mounted screws.
- These openings are also suitable for mounting the speaker to a wall bracket. Alternatively, you can use the threaded hole on the bottom of the speaker. When delivered, the threaded hole contains a screw that must be removed before installation. You will find suitable speaker stands and wall brackets in our webshop ([www.teufelaudio.com](http://www.teufelaudio.com)) in the “Accessories” area.

## Connecting

### CAUTION

#### *Risk of tripping!*

- Lay the cables so that they do not pose a tripping hazard.
1. Switch your AV receiver or multi-channel active subwoofer off.
  2. Lay a speaker cable from your AV receiver or multi-channel active subwoofer to the speaker. Use a high-quality double wire speaker cable with marked strands for this. The cross-section should amount to at least 1.5 mm<sup>2</sup>.

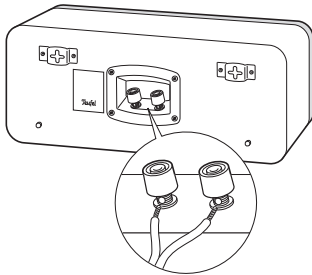

Use the connection terminal with the two clamps on the back of the speaker to connect the speaker cables. The terminals are each marked red (+) and black (-).

### NOTICE

**Make sure the polarity is correct!**

- Connect each of the like coloured terminals of your speaker and your amplifier with one another; otherwise the sound quality will suffer. To facilitate this, the individual single wires of the speaker cables are marked with different colours or shapes.

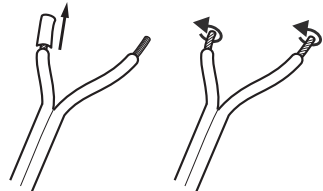

3. Split the single wire down by approx. 30 mm on both ends and remove approx. 10 mm of insulation each.
4. Twist the stripped wire ends so that no strands are protruding. Tin coating is not necessary.
5. Turn the connector terminal counterclockwise until loose. Run the stripped cable end into the now visible hole. Close the terminal by turning it counter-clockwise. The cable has now been clamped in place.



6. Connect the speaker cable to your AV receiver or multi-channel active subwoofer. You should be able to find corresponding notes in the user manual of your device.

## **Removing the protective grid**

You can remove the protective grid by carefully reaching behind it and slowly pulling it off to the front.

By removing the protective grid, especially high frequencies will sound clearer.

When putting the protective grid on, please make sure that the installation pins slide directly into the corresponding jacks on the speaker.

## **Crossover frequency**

We recommend a crossover frequency of 80–100 Hz. Where possible, set your AV receiver or DecoderStation as close as possible to this value.

Operation in full-range mode is also possible (all speakers set to “Large”). However, the maximum volume is slightly lower in this case.

## Care and Cleaning

---

The veneered surfaces of our speakers have a protective surface coat so they no wood polish is necessary.

### **NOTICE**

***External influences may damage or destroy the device.***

- If possible, only use plain water without any additives. In case of stubborn marks, a mild soap solution may be used.*
- Do not use caustic cleaning products, white spirit, thinners, petrol or similar under any circumstances. Such cleaning agents may damage the delicate surface of the housing.*

- Ideally, you should remove dust or small amounts of dirt with a dry, smooth leather cloth.
- Rub off stubborn dirt with a damp cloth. Make sure that no liquid penetrates the speakers.
- Then immediately wipe the surfaces dry with a soft cloth without applying pressure.

## Technical Data

---

Impedance	4 – 8 $\Omega$
Sinus power	100 Watt (longterm), 150 Watt (shortterm)
X-over frequency:	4000 Hz
Recommended cross-over frequency when using a subwoofer:	100 Hz
Dimensions (W x D x H)	420 x 185 x 178 mm
Net weight	5.4 kg

You can find further technical data on our website.  
Technical changes reserved!

## Declaration of Conformity

---



Lautsprecher Teufel GmbH declares that this product complies with the relevant European and national directives. The full text of the CE Declaration of Conformity can be found at this web address:

[www.teufel.de/konformitaetserklaerungen](http://www.teufel.de/konformitaetserklaerungen)

[www.teufelaudio.com/declaration-of-conformity](http://www.teufelaudio.com/declaration-of-conformity)

# Disposal

---

## Important information in accordance with the Electrical and Electronic Equipment Act (Germany: ElektroG)

We advise owners of electrical and electronic appliances that old electrical and electronic devices must be handed in separately from municipal waste, in accordance with the applicable regulations. Batteries and rechargeable batteries that are not firmly enclosed in old electrical devices and lamps, and that can be removed from the old device without destroying them, must be separated from them in a non-destructive manner before they are handed to the collection point for their intended disposal. Please take note of our information on the Batteries Act [Germany: BattG] below for disposing of batteries.

You make an important contribution to returning, recycling and further processing of old devices if you separate your old devices into the correct collection groups for recycling.

The symbol below of a crossed-out dustbin, applied to electrical and electronic appliances, also advises of the duty to separate collections:



Consumer electronics stores and supermarkets are obliged, under certain conditions, to take back old electrical and electronic devices, in accordance with section 17 of the Electrical and Electronic Equipment Act. Stationary retailers must take back an old electrical device of the same type when a new electrical device is bought (1:1 return). This also applies to home deliveries. These retailers must also take back up to three small old electrical devices ( $\leq 25\text{cm}$ ) without this being linked to a new purchase (0:1 return). In accordance with the Electrical and Electronic Equipment Act, as online retailers of electrical devices and due to our product range, our obligation is limited to 1:1 return of large devices of  $> 50\text{ cm}$  when selling a new electrical or electronic device of the same type. We comply with the obligation of return of devices other than large devices through our service provider. You can find the exact contact data and collection points on our website [www.Teufel.de/entsorgung](http://www.Teufel.de/entsorgung). It is also possible to return old electrical and electronic appliances free of charge at an official delivery point run by the public waste disposal authorities.

**Important:** For safety reasons we ask that you refrain from sending lighting fixtures (some lamps). For return of lighting fixtures please use the public waste disposal collection points or contact us directly at [www.Teufel.de/entsorgung](http://www.Teufel.de/entsorgung).

As an end-user, you are responsible for deleting any personal data on old electrical appliances before handing it in.

**Important:** Our appliances can contain batteries/rechargeable batteries. If this is the case, please refer to its attached product documentation for additional information on the type and chemical make-up of the battery. For products with battery compartments you can directly remove the batteries or rechargeable batteries and dispose of them properly. If the batteries are built in to the product, do not in any case attempt to remove the batteries yourself, instead contact one of our employees or appropriate specialist staff.





# Teufel

Please contact our customer service department with any questions, suggestions, or complaints:

Lautsprecher Teufel GmbH  
BIKINI Berlin, Budapester Straße 44  
10787 Berlin (Germany)

[www.teufelaudio.com](http://www.teufelaudio.com)

Phone: 00800 200 300 40 (toll-free)

Fax: +49 (0)30 - 300 930 930

Online-support:

[www.teufelaudio.com/service](http://www.teufelaudio.com/service)

Contact:

[www.teufelaudio.com/contact](http://www.teufelaudio.com/contact)

No responsibility is assumed for the correctness of this information.  
Technical changes, typographical errors and other errors reserved.