

Teufel

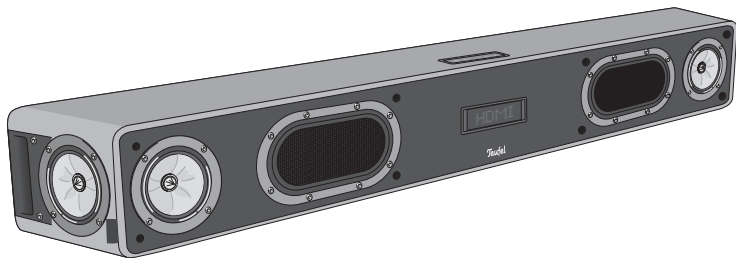

manuals.teufelaudio.com

Cinebar Ultima





Lieferumfang

Scope of delivery / Contenu de la livraison

Ambito di consegna / Volumen de suministro

Leveringsomvang / Zakres dostawy

All-in-One Soundbar mit integrierter
PC-Soundkarte

All-in-One Soundbar with integrated PC
Soundcard

Barre de son tout-en-un avec carte son PC
intégrée

Soundbar tutto-in-uno con scheda audio
per PC integrata

Barra de sonido todo en uno con tarjeta de
sonido para PC integrada

Alles-in-één soundbar met geïntegreerde
pc-geluidskaart

Soundbar typu all-in-one z wbudowaną
kartą dźwiękową do PC

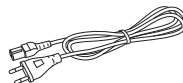
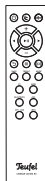
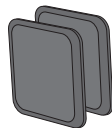
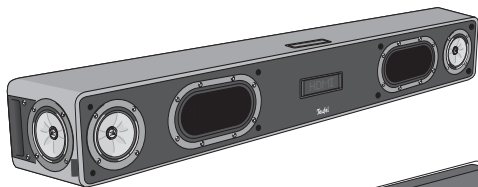



Montage (optional)

Assembly (optional) / Montage (optionnel)

Montaggio (opzionale) / Montaje (opcional)

Montage (optioneel) / Montaż (opcjonalnie)

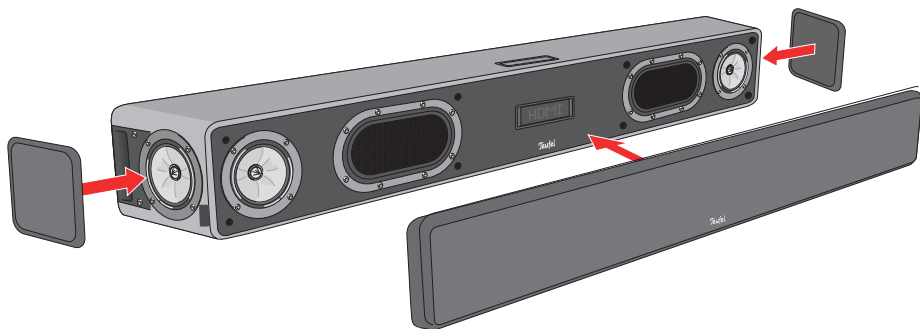



Batterien wechseln

Replace batteries / Remplacer les piles

Sostituire le batterie / Cambiar las baterías

Batterijen vervangen / Wymień baterie

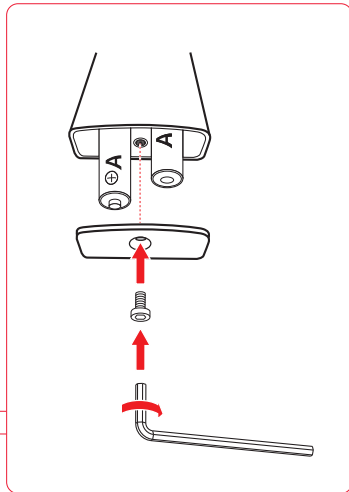
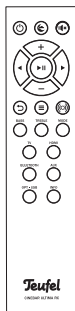



Netzanschluss

Mains connection / Raccordement au secteur

Collegamento alla rete / Conexión a la red

Netaansluiting / Przyłączenie do sieci

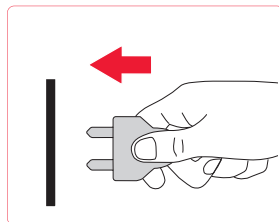
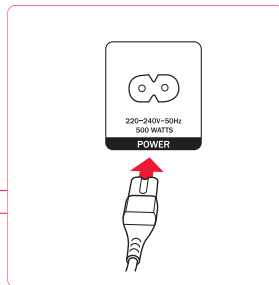
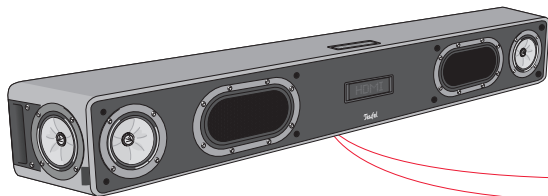



HDMI ARC

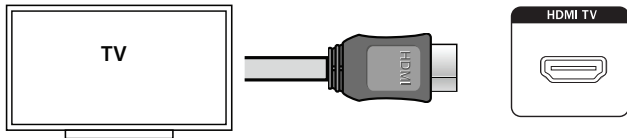
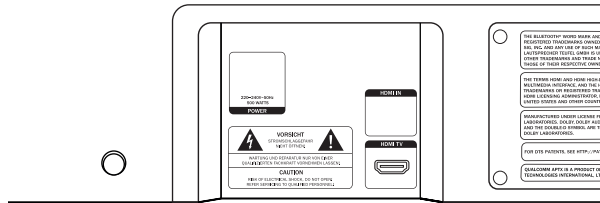



Pairing mit Rear-Lautsprechern

Pairing with and speakers / Couplage avec haut-parleurs arrières

Combinazione con altoparlanti rear / Emparejamiento con altavoces traseros

Koppelen met achterste luidsprekers / Parowanie z tylnymi głośnikami

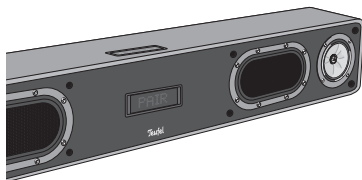

Rears:

- Menu ▶
- Speaker ▶
- Pair ▶
- Pairing

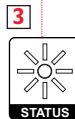
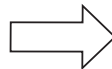
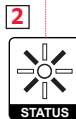
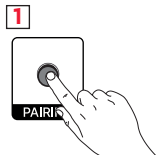



Bluetooth® Verbindung

Bluetooth® connection / Connexion Bluetooth®

Connessione Bluetooth® / Conexión Bluetooth®

Bluetooth®-verbinding / Połączenie Bluetooth®

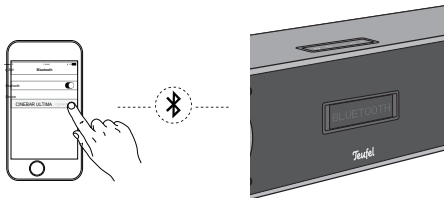
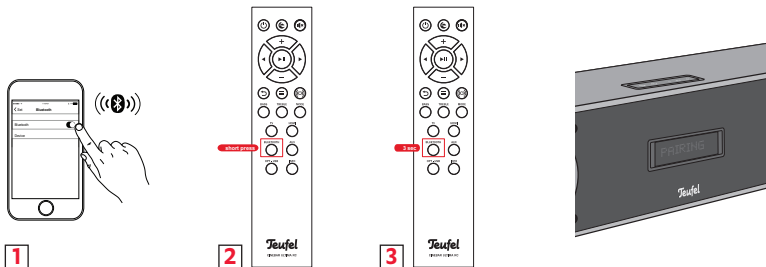



Anschlussarten

Connection types / Types de raccordement

Tipi di collegamento / Tipos de conexión

Typen aansluitingen / Rodzaje połączeń

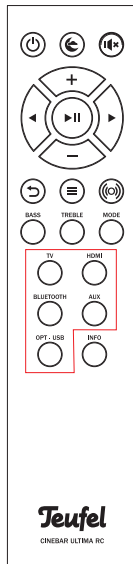
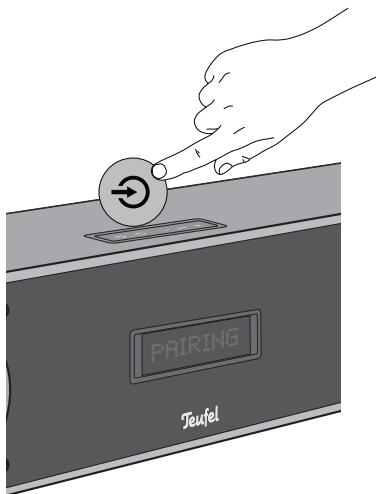



Anschlussarten

Connection types / Types de raccordement

Tipi di collegamento / Tipos de conexión

Typen aansluitingen / Rodzaje połączeń

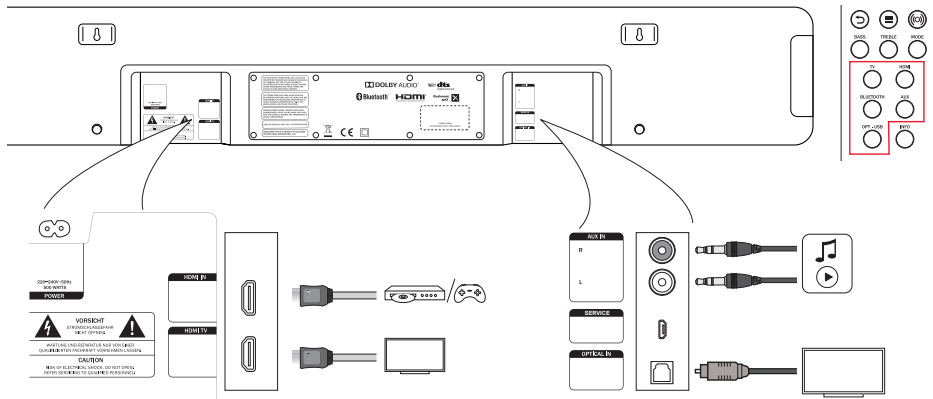



Technische Daten

Technical data / Données techniques

Dati tecnici / Datos técnicos

Technische gegevens / Dane techniczne

Abmessungen (B x H x T) / Dimensions (W x H x D) / Dimensions (L x H x P) Dimensioni (largh. x alt. x prof.) / Dimensiones (An x Al x Pr) Afmetingen (b x h x d) / Wymiary (szer. x wys. x gł.)	1100 x 131 x 138 mm
Gewicht / Weight / Poids / Peso / Peso / Gewicht / Ciężar	11.2 kg
Stromversorgung / Power supply / Alimentation électrique / Alimentazione elettrica Suministro eléctrico / Stroomvoorziening / Zasilanie elektryczne	220-240 V~, 50 Hz, 400 W max.

Funknetz / Radio network Réseau radio / Rete radio / Red de radio Draadloos netwerk / Sieć radiowa	Frequenzbänder / Frequency bands Bandes de radiofréquence Bande di frequenza / Bandas de frecuencias Frequencybanden / Zakresy częstotliwości	Sendeleistung / Transmission power Puissance d'émission / Potenza di trasmissione Potencia de transmisión / Zendermogen Moc transmisji
Bluetooth®	2,400–2,483.5 MHz	2.5/4 mW/dBm
Funklautsprecher / Wireless speaker Haut-parleur sans fil / Altoparlante senza fili / Altavoz inalámbrico / Draadloze luidspreker / Głośnik bezprzewodowy	2.405–2.477 MHz	1/0 mW/dBm

© All trademarks and brand names are the property of their respective owners.



The Bluetooth® word mark and logos are registered trademarks owned by Bluetooth SIG, Inc. and any use of such marks by Lautsprecher Teufel GmbH is under license. Other trademarks and trade names are those of their respective owners.



Manufactured under licence from Dolby Laboratories. Dolby, Dolby Audio, Pro Logic and the double D symbol are trademarks of Dolby Laboratories.



The terms HDMI, HDMI High-Definition Multimedia Interface, HDMI Trade dress and the HDMI Logos are trademarks or registered trademarks of HDMI Licensing Administrator, Inc.



For DTS patents, see <http://xperi.com/dts-patents/>.
Manufactured under license from DTS, Inc. and its affiliates. DTS, the DTS logo, and digital surround are registered trademarks or trademarks of DTS, Inc. and its affiliates in the United States and/or other countries. © DTS, Inc. and its affiliates. All rights reserved.



Qualcomm aptX is a product of Qualcomm Technologies International, Ltd. Qualcomm is a trademark of Qualcomm Incorporated, registered in the USA and other countries, whose use has been approved. aptX is a trademark of Qualcomm Technologies International, Ltd., registered in the USA and other countries, whose use has been approved.



Lautsprecher Teufel GmbH declares that this product complies with Directive 2014/53/EU. The full text of the EU Declaration of Conformity can be found at this web address:

teufel.de/konformitaetserklaerungen
teufelaudio.com/declaration-of-conformity

Teufel

Lautsprecher Teufel GmbH

Bikini Berlin

Budapester Str. 44
10787 Berlin

teufelaudio.com
teufel.de
teufel.ch
teufelaudio.at
teufelaudio.nl

teufelaudio.be
teufelaudio.fr
teufelaudio.pl
teufelaudio.it
teufelaudio.es

Telefon:

Deutschland: +49 (0)30 217 84 217
Österreich: +43 12 05 22 3
Schweiz: +41 43 50 84 08 3
International: 00800 200 300 40
(toll-free)

Telefax:

+49 (0)30 / 300 930 930

Online-Support:

teufel.de/support
teufelaudio.com/support

Kontaktformular/

Contact:

teufel.de/kontakt
teufelaudio.com/contact

Teufel_Cinebar Ultima_QSG_V1.0 HC