



## **Columa 100**

**Active subwoofer US 5108/1**

***Teufel***

## Technical description and operating instructions

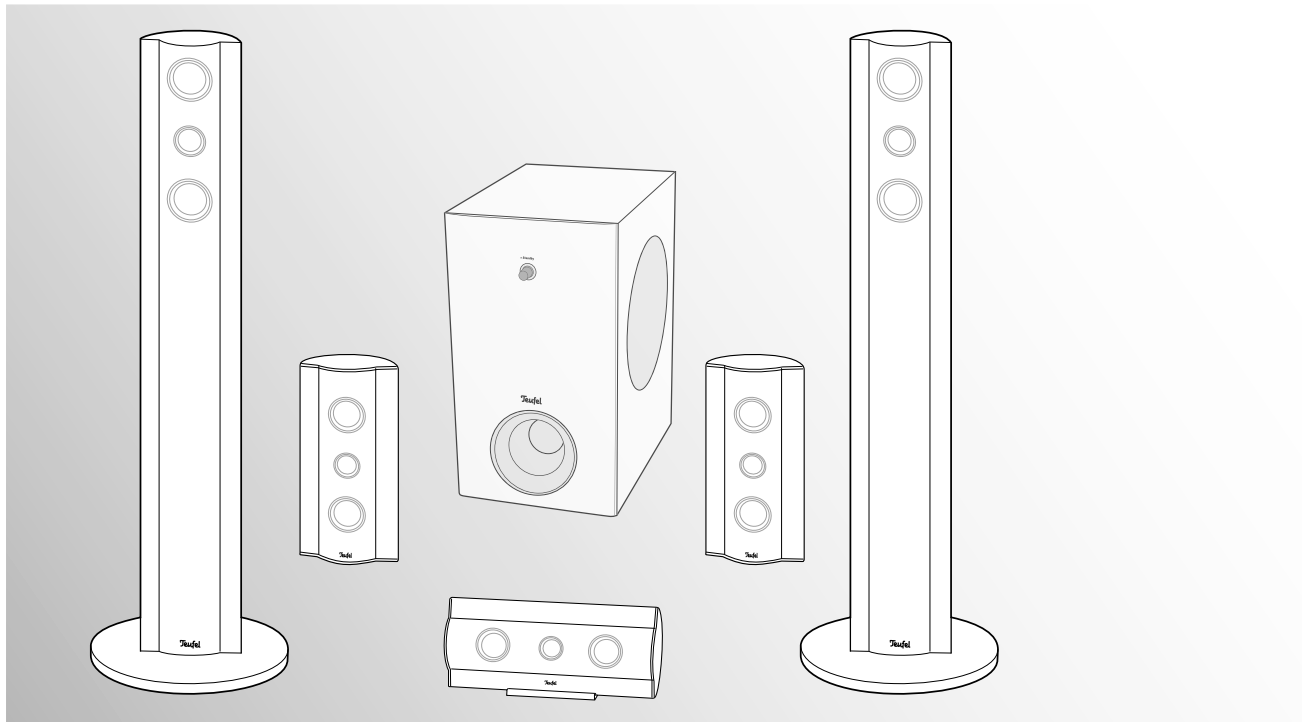

# Columa 100

## 5.1 Home Cinema Speaker Set Operating instructions for satellite speakers

**Teufel**

## Contents

Product contents	2
General notes and information	3
Safety notes	4
Setup	5
Assembly	5
Connection and settings	6
Troubleshooting	7
Care and cleaning	8
Protecting the environment	8
Technical data	8

## Product contents

- ① 4 x satellite speakers  
(exact types depend on the ordered set). Following combinations are possible:
- 4 floor speakers (each with a base plate and three fastening screws)
  - or
  - 2 satellite and 2 floor speakers

- ② 1 x center speaker

The corresponding active subwoofer for this 5.1 home cinema speaker set is packed in a separate box.

- Check that all items have been delivered and that nothing is damaged.
- If the delivery is incomplete or you find damage sustained in transit, do not use the product, instead contact our service department (see page 3).

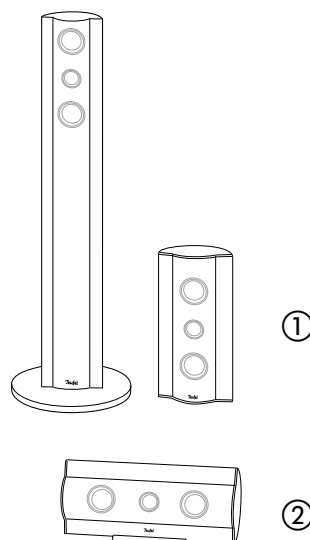

# General notes and information

## Notice

The information in this document may be changed without prior notice and in no way constitutes any liability on the part of Lautsprecher Teufel GmbH.

No part of these instructions may be reproduced in any form or be broadcasted in any way electronically, mechanically, by photocopy or recording without the written permission of Lautsprecher Teufel GmbH.

© Lautsprecher Teufel GmbH  
Version 1.0  
April 2010

## Original packaging

If you wish to exercise your eight-week right of return, we ask that you be absolutely sure to hold onto the packaging. We can only accept the return of the speakers WITH THE ORIGINAL PACKAGING.

Empty boxes are not available!

## Complaints

In case of complaint we will need the following information to process your enquiry:

### 1. Invoice number

Can be found on the sales slip (enclosed with the product) or on the order confirmation received as a PDF document, e.g. 4322543

### 2. Serial number and/or batch number

Can be found on the back of the device,  
e.g. serial number: CL30000240129A-123.

Many thanks for your support!

## Contact

For questions, suggestions or criticism please contact our customer service department:

Lautsprecher Teufel GmbH  
Gewerbehof Buelowbogen · Buelowstrasse 66  
10783 Berlin (Germany)

**Tel.: 00800 - 200 300 40 (free of charge)**

**Fax: +49 (0)30 - 300 930 930**

**[www.teufelaudio.com](http://www.teufelaudio.com)**

## Proper use

Only use the speakers as described in these instructions. Any other use will be deemed as not in accordance with the instructions and may lead to damage to property or even persons. The manufacturer accepts no liability for damage caused by use not in accordance with the instructions.

The unit is intended for private use.



Before using the speakers for the first time please first read the safety notes and operating instructions carefully. This is the only way to use all functions safely and reliably.

Keep the operating instructions safe and pass them on to anyone who may own the unit after you.

## Safety notes

### Caution icons

You will find the following caution icons used in these instructions:

---

**Danger High risk!**

Failure to observe the warning may result in severe personal injury or death.

---

**Attention Moderate risk!**

Failure to observe the warning may result in property damage.

**Minor risk!**

Points which should be observed when handling the unit.

---

### Safety notes

---

**Danger Danger to children!**

Children can become trapped in the packing film when playing and suffocate.

- Do not allow children to play with the unit or the packing film. Danger of suffocation.
  - Ensure that children do not remove small parts from the unit or take them off of the unit (e.g. control knobs or plug adapters). They could swallow the parts and choke. Never allow children to use electrical devices without supervision.
- 

**Danger Danger to hearing!**

Loud noise may lead to hearing loss.

There is a potential risk of sudden very high noise pressure especially when activating the subwoofer which is set to full volume. This may have psychological consequences and also cause physical injury. Children and pets are particularly at risk.

- Set your signal source unit volume control to a low setting.
  - When the volume is set high, always keep a certain distance from the unit and never place your ear directly on the speaker.
  - To avoid damage to health, avoid extended listening at high volume.
- 

---

**Danger Danger of injury/damage!**

Incorrect location may result in damage.

- Never use the unit unmounted in vehicles, in unstable locations, on wobbly tripods or furniture, on underdimensioned brackets etc. The speakers could tip or fall down and cause injury to persons or be damaged.
  - Arrange the speakers so that they cannot be knocked over accidentally and make sure that the cables do not pose a trip hazard.
  - Ensure that any wall mounting is performed in a professional manner.
  - Only use suitable wall brackets for mounting. Check the carrying capacity of the walls.
  - Do not place the unit near sources of heat (e.g. heaters, ovens, other heat generating equipment such as amplifiers etc.)
- 

**Attention Fire hazard!**

Improper use may lead to damage or fire.

- Do not place open flames such as burning candles or similar on the unit.
  - Ensure sufficient ventilation.
  - Do not place the unit in direct sunlight.
  - Use the unit in indoor areas only.
  - Do not use the appliance in damp rooms and protect it from water drops and splashes. Ensure that no vases or other vessels filled with liquid are placed on or near the appliance to prevent the housing from being penetrated by liquid.
-

## Setup

### Setup tips

- Select a stable, level base and/or a suitable wall.
- Make sure that the environment is clean and free of dust.
- Avoid placing the unit close to sources of heat or in direct sunlight.
- Do not place any heavy objects on the cables or the speakers.

### Center speakers

- Place the center speaker in a central position under or next to the screen.

### Front speakers

- The front speakers are set up to the right and left of the screen or hung at a height of approx. 80 cm to 160 cm.
- They should be in line with the center speaker and form an equilateral triangle with the listener – the so called stereo triangle (distance from the listener = distance between the speakers).
- The speakers should project sound directly into the room or slightly towards the listener.

### Rear speakers

- The rear speakers are set up or wall mounted to the side (a) or behind (b) the listener at a height of 1.20 m to 2.10 m.
- The distance to the listener should amount to at least 100 cm.

### Subwoofer

- The position of the subwoofer can be selected as desired and does not affect the other speakers. An ideal position is often between the front speakers.

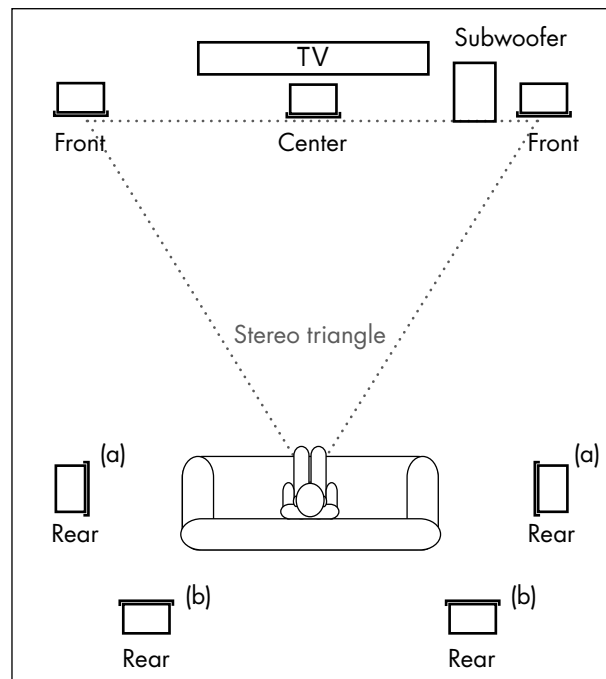

## Assembly

### Mounting the base plate

To mount the base plate on the floor speakers, you will need a size 0 Philips screwdriver.

Secure the base plate on the bottom end of the floor speaker (see graphic) using the three enclosed screws. Make sure that the screws are seated in the threading of the speaker such that they are perfectly straight and do not excessively tighten the screws.

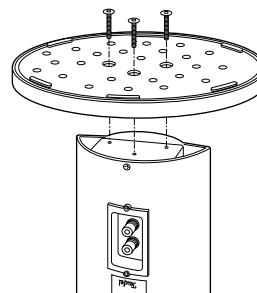

## Wall mounting

### **Danger Risk of damage!**



Incorrect location may result in damage.

- Ensure that any wall mounting is performed in a professional manner.
  - Only use suitable wall brackets for mounting. Check the carrying capacity of the walls.
- 
- You can mount the satellite speakers on a wall using the brackets on the back of the speakers or you can screw them on a support foot.
  - You can purchase installation materials (cables, support feet, wall brackets and resonance dampers) especially for these speakers in our webshop ([www.teufelaudio.com](http://www.teufelaudio.com)) in the "Accessories" area.
  - You can set up the center speaker or mount it on a wall using its frame.

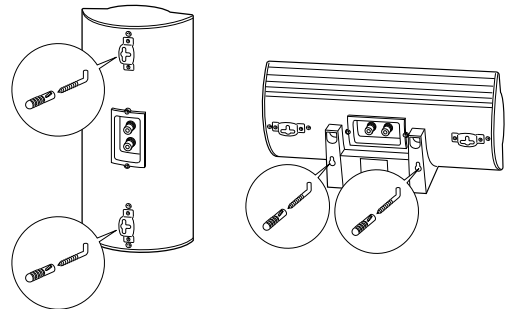

## Connection and settings

### **Danger Danger of injury/damage!**



Arrange the cables so that they do not pose a trip hazard.

#### Satellite speakers

- Pull the mains plug of your AV receiver out of the socket.
- Lay the speaker cables from your AV receiver to each of the speakers. This cable should be a high-quality double-wire speaker cable with marked strands. The cross-section should amount to at least 1.5 mm<sup>2</sup>.
- A connector terminal with two terminal clips is located on the back of each speaker. You optionally can connect the speaker cables using pin plugs. Here we describe the direct connection without using pin plugs.
- The terminals are each marked red (+) and black (-).



#### **Make sure the polarity is correct!**

Always connect terminals with the same colour with each other. Otherwise the sound quality will suffer. The wires of the speaker cables are marked with different colours or shapes.

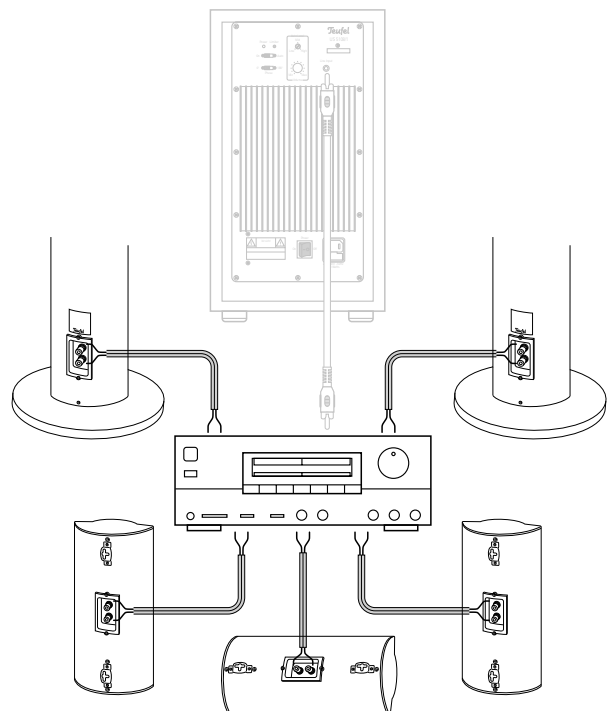

1. Split the single wires on both ends for approximately 30 mm and remove 10 mm of the insulation on each wire.
2. Twist the copper core so that no strands are protruding.
3. Turn the connector terminal counterclockwise until loose.
4. Run the stripped cable into the hole that is now visible. Turn the terminal clockwise. The cable is now clamped in place.
5. Connect all speaker cables this way.
6. Connect the speaker cables to your AV receiver. The operating instructions of the appliance should contain notes on this.

#### Subwoofer

- Connect the subwoofer as described in the corresponding operating instructions.

#### Crossover frequency

- The optimal crossover frequency for the Columa 100 system amounts to 150 Hz. Set your AV amplifier to this value to the extent possible.

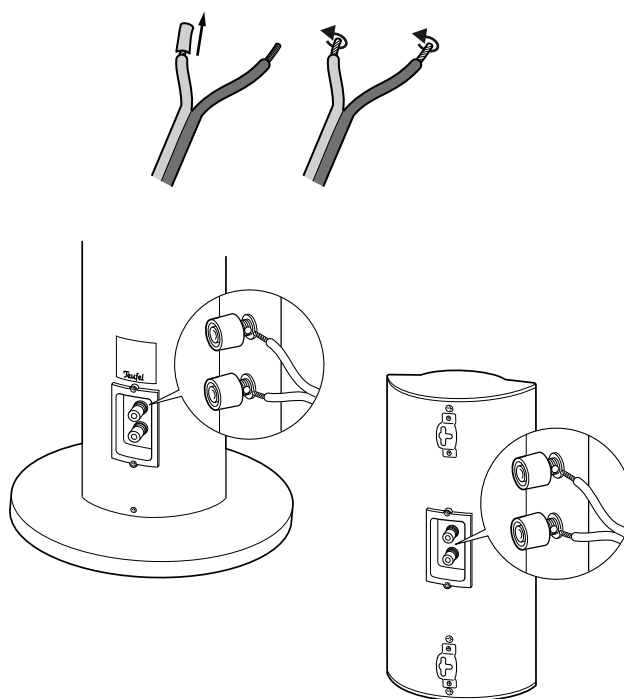

## Troubleshooting

The following instructions should help you to solve problems. If this doesn't work, please contact our hotline (see page 3). Mind the warranty instructions.

Problem	Possible cause	Solution
Playback is noisy.	Generally speaking, the system is very low-noise. In the high range area, very good-quality high-resolution speaker systems can expose the poor quality of a signal source (e.g. from MP3 files).	Ensure that the source is sending a clean signal.
The sound seems dull.	The speakers have been connected with the wrong poles.	Make sure the speaker cables of all satellites are connected properly.



## Care and cleaning

Clean your speakers regularly with a soft, damp micro-fiber cloth. In the process, be absolutely sure to observe the following notes:

- If possible use only plain water with no cleaning products. In case of stubborn marks, a mild soap solution may be used.

- In no circumstances should caustic cleaning products, white spirit, thinners, petrol or similar be used for cleaning.

## Protecting the environment

### Disposing of the unit



**Used units must not be disposed of with household waste.**

If the unit is no longer operational, every consumer is required by law to dispose of used devices separate from household waste, e. g. at a collection point run by the communal author-

ity borough. In this way, used devices can be recycled and waste materials disposed of in an environmentally friendly manner.

For this reason, electrical equipment is labelled with the displayed symbol

## Technical data

### Satellite and Center Speakers

Impedance: 4–8 Ohm  
Dimensions (W x H x D): 16.4 x 35 x 8.6 cm  
Net weight: 1.5 kg

### Floor speakers

Impedance: 4–8 Ohm  
Dimensions (W x H x D): 16.4 x 108 x 8.6 cm  
Net weight: 4.7 kg

Technical changes reserved!

 This product conforms with Council of the European Union guidelines 2004/108/EC and 2006/95/EC

# Teufel

For questions, suggestions or other issues please contact our customer service department:

**Lautsprecher Teufel GmbH**  
Gewerbehof Bülowbogen - Ausgang D1  
10783 Berlin (Germany), Bülowstr. 66

Tel.: 00800 200 300 40 (toll-free)  
Fax: +49 (0)30-300 930 930  
[www.teufelaudio.com](http://www.teufelaudio.com)

No liability is accepted for the accuracy of this information. Technical changes, typographical errors and other errors reserved.

## Technical description and operating instructions

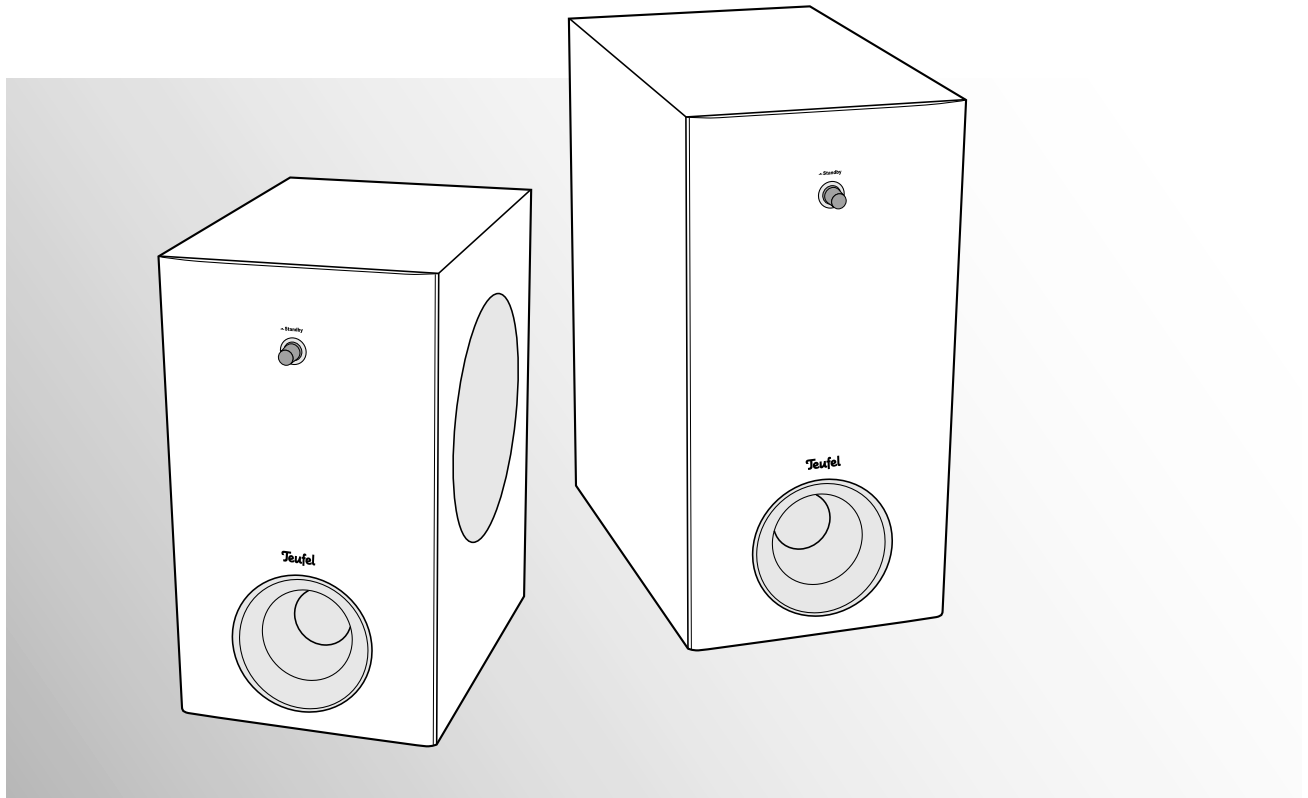

## Active subwoofer

US 5108/1

US 5110/1

**Teufel**

# Contents

---

<b>General notes and information</b> . . . . .	<b>3</b>
Notice . . . . .	3
Original packaging . . . . .	3
Complaints . . . . .	3
Contact . . . . .	3
Proper use . . . . .	3
<b>Safety notes</b> . . . . .	<b>4</b>
Caution icons . . . . .	4
Safety notes . . . . .	4
<b>Product contents, control elements and connections</b> . . . . .	<b>5</b>
Product contents . . . . .	5
Control elements and connections . . . . .	5
Subwoofer back side . . . . .	5
<b>Connection and operation</b> . . . . .	<b>6</b>
Signal connection . . . . .	6
Connecting to a power supply . . . . .	6
Automatic activation/deactivation . . . . .	6
Changing the input sensitivity of the automatic activation . . . . .	6
<b>Troubleshooting</b> . . . . .	<b>7</b>
<b>Care and cleaning</b> . . . . .	<b>7</b>
<b>Protecting the environment</b> . . . . .	<b>8</b>
Disposing of the unit . . . . .	8
<b>Technical data</b> . . . . .	<b>8</b>

# General notes and information

## Notice

The information in this document may be changed without prior notice and in no way constitutes any liability on the part of Lautsprecher Teufel GmbH.

No part of these instructions may be reproduced in any form or be broadcasted in any way electronically, mechanically, by photocopy or recording without the written permission of Lautsprecher Teufel GmbH.

© Lautsprecher Teufel GmbH  
Version 1.0  
Mai 2010

## Original packaging

If you wish to exercise your eight-week right of return, we ask that you be absolutely sure to hold onto the packaging. We can only accept the return of the speakers WITH THE ORIGINAL PACKAGING.

Empty boxes are not available!

## Complaints

In case of complaint we will need the following information to process your enquiry:

### 1. Invoice number

Can be found on the sales slip (enclosed with the product) or on the order confirmation received as a PDF document, e.g. 4322543

### 2. Serial number and/or batch number

Can be found on the back of the device,  
e.g. serial number: CL30000240129A-123.

Many thanks for your support!

## Contact

For questions, suggestions or criticism please contact our customer service department:

Lautsprecher Teufel GmbH  
Gewerbehof Buelowbogen · Buelowstrasse 66  
10783 Berlin (Germany)

**Tel.: 00800 - 200 300 40 (free of charge)**

**Fax: +49 (0)30 - 300 930 930**

**[www.teufelaudio.com](http://www.teufelaudio.com)**

## Proper use

Only use the unit as described in these instructions. Any other use will be deemed as not in accordance with the instructions and may lead to damage to property or even persons. The manufacturer accepts no liability for damage caused by use not in accordance with the instructions.

The unit is intended for private use.



Before operating the unit for the first time please read the safety notes and operating instructions carefully. This is the only way to use all functions safely and reliably.

Keep the operating instructions safe and pass them on to anyone who may own the unit after you.

## Safety notes

### Caution icons

You will find the following caution icons used in these instructions:

---

**Danger High risk!**

Failure to observe the warning may result in severe personal injury or death.

---

**Attention Moderate risk!**

Failure to observe the warning may result in property damage.



---

**Minor risk!**

Points which should be observed when handling the unit.

---

### Safety notes

---

**Danger Risk of electric shock!**

Faulty installation of electrical equipment or mains voltage which is too high can cause

electric shocks.

- The device is only suitable for use with a power supply voltage of 220–240 V~/50 Hz.
- If the unit's case or mains cable is defective or shows other signs of visible damage, disconnect the mains adapter immediately from the socket and do not operate the device.
- If the unit emits smoke or smells of burning or other unusual odours, disconnect it immediately from the power supply and do not operate it.
- Never open the unit case.  
Repairs may only be carried out by an authorised specialist workshop. Only use parts which conform with the original unit specifications. There are electrical and mechanical parts in this unit which are essential in order to avoid exposure to sources of danger.
- Do not insert any object through the vent slots in the case.
- Only use the unit in indoor areas.
- Do not operate the unit in moist areas and protect it from drops of water or splash water.

Also take care not to stand vases or other containers of liquid on or near the unit in order to avoid liquid getting into the case. If water or other foreign objects should enter the case, disconnect the device immediately from the mains power supply and remove any batteries. Send the unit to our service address.

- Never touch the mains adapter with wet hands.
  - Check the unit regularly for damage.
- 

---

**Danger Danger to children!**

Children can become trapped in the packing film when playing and suffocate.

- Do not allow children to play with the unit or the packing film. Danger of suffocation.
  - Ensure that children do not remove small parts from the unit or take them off of the unit (e.g. control knobs or plug adapters). They could swallow the parts and choke. Never allow children to use electrical devices without supervision.
- 

---

**Danger Danger to hearing!**

Loud noise may lead to hearing loss.

There is a potential risk of sudden very high noise pressure especially when activating the subwoofer which is set to full volume. This may have psychological consequences and also cause physical injury. Children and pets are particularly at risk.

- Set your signal source unit volume control to a low setting.
  - When the volume is set high, always keep a certain distance from the unit and never place your ear directly on the speaker.
  - To avoid damage to health, avoid extended listening at high volume.
- 

---

**Danger Danger of injury/damage!**

Incorrect location may result in damage.

- Never use the unit unmounted in vehicles, in unstable locations, on wobbly tripods or furniture, on underdimensioned brackets etc. The speakers could tip or fall down and cause injury to persons or be damaged.
  - Arrange the speakers so that they cannot be knocked over accidentally and make sure that the cables do not pose a trip hazard.
  - Ensure that any wall mounting is performed in a professional manner.
  - Only use suitable wall brackets for mounting. Check the carrying capacity of the walls.
  - Do not place the unit near sources of heat (e.g. heaters, ovens, other heat generating equipment such as amplifiers etc.).
- 

---

**Attention Risk of damage!**

Power overload due to lightning strike may damage or destroy the unit.

- If the unit is to be left unsupervised for a long period (e.g. during a holiday), or if a thunderstorm is forecast, disconnect it from the mains power supply.
-

### Attention Fire hazard!



Improper use may lead to damage or fire.

- Do not place open flames such as burning candles or similar on the unit.
- Ensure sufficient ventilation.
- Do not place the unit in direct sunlight.
- Do not cover the ventilation slots with curtains, cloths, newspapers or similar. Heat build-up inside the unit can shorten the lifetime of the unit.



### Check to be sure!

Check that all items have been delivered and that nothing is damaged.

- If the delivery is incomplete or you find damage sustained in transit, do not operate the unit but contact our service department (see page 3).

## Product contents, control elements and connections

### Product contents

- 1 x active subwoofer US5108/1 or US5110/1
- 1 x mains cord

### Control elements and connections

#### Subwoofer back side

Pos	Name	Description
1	Phase	Activate/deactivate phase shift (180°) for the subwoofer
2	On/Auto	Switch for automatic activation
3	Power	Power LED
4	Limiter	The limiter LED illuminates when the amplifier reaches a distortion factor of 3–4% (corresponds to an output of 120 watts at 4 ohm)
5	Auto Level	Set the input sensitivity of the automatic activation
6	Volume	Volume control for subwoofer
7	Line Input	Audio input jack
8	–	Connector jack for mains cord
9	–	Mains fuse
10	Power On/Off	Mains switch
11	Standby	Switch subwoofer on or to standby <b>On:</b> Illumination around the push-button is blue <b>Standby:</b> Illumination around the push-button is orange

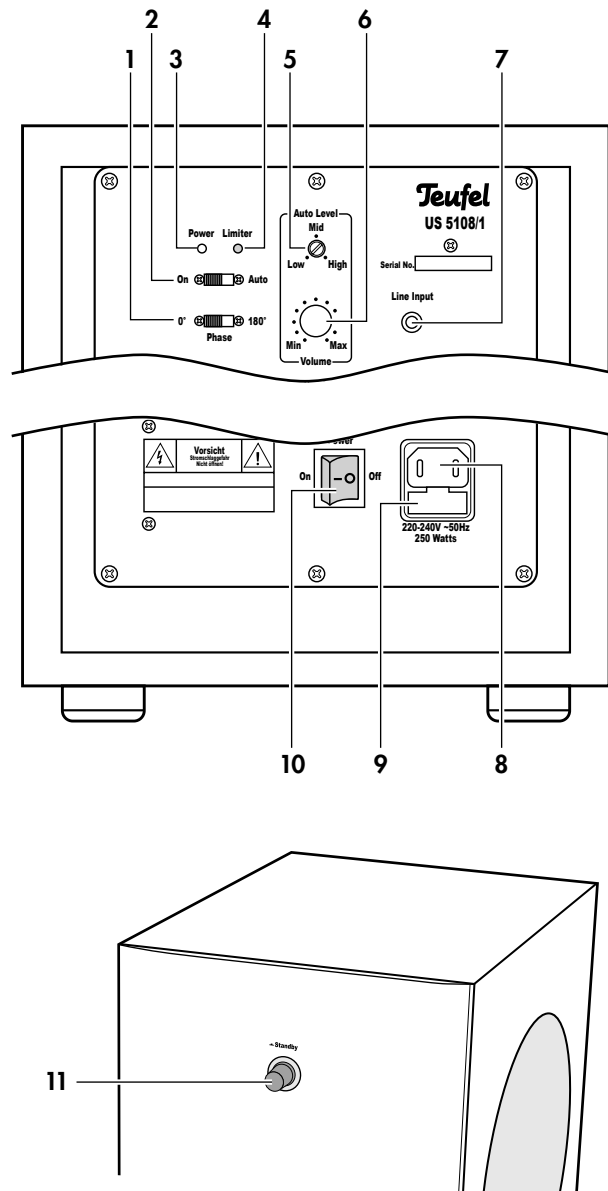

# Connection and operation

## Danger Danger of injury/damage!



Arrange the cables so that they do not pose a trip hazard.

## Subwoofer

### Signal connection

- Connect the RCA jack **7** "Line Input" on the back side of the subwoofer and the RCA jack for the subwoofer on the receiver with a mono RCA connector cable.
- For more information, please consult the operating instructions for your receiver.

### Connecting to a power supply

- Ensure that the mains switch **10** "Power" on the subwoofer is switched off ("O OFF" position).
- Connect the mains connector jack **8** with a mains socket using the mains cord.

## Satellite speakers

- Connect the satellite speakers as described in the corresponding operating instructions.

## Activating and deactivating

- With the "Power" switch **10**, you can turn the subwoofer on or off. If the subwoofer is on, the "Power" LED **3** will illuminate.

### Automatic activation/deactivation

- Switch **2**:
  - **Auto** position: The subwoofer turns on as soon as an audio signal is present at the line input **7** (LED **3** is blue).
  - If no audio signal is present for 30 minutes, the subwoofer switches to standby (LED **3** is orange).
  - **On** position: The subwoofer is always on.

### Changing the input sensitivity of the automatic activation

- With the control **5** "Auto Level", you can change the sensitivity of the automatic activation. This makes sense if the subwoofer doesn't turn on even if an audio signal is present and/or it is activated by a disturbing impulse.
- Use a narrow screwdriver to turn the controller.

## Volume

- Adjust the subwoofer volume with the volume control **6** "Volume".

## Phase

- With the switch **1** "Phase", you activate and deactivate the phase shift (180°) for the subwoofer, which may improve the sound under certain circumstances.

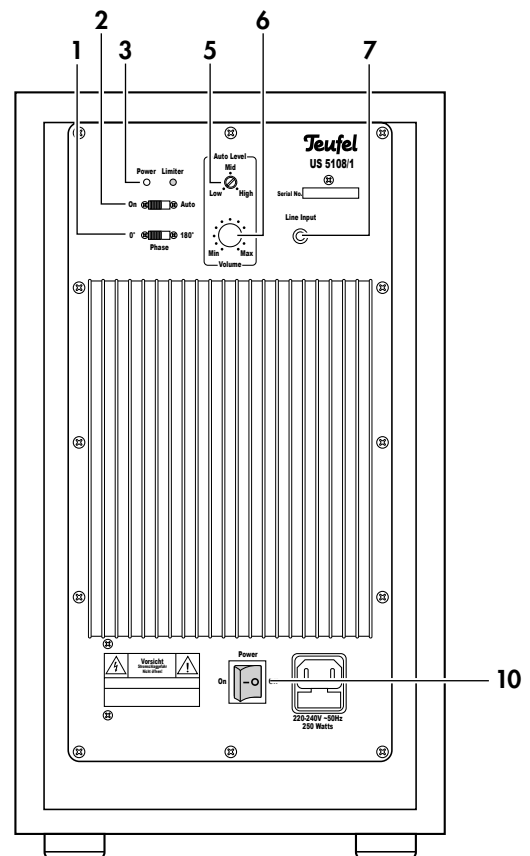
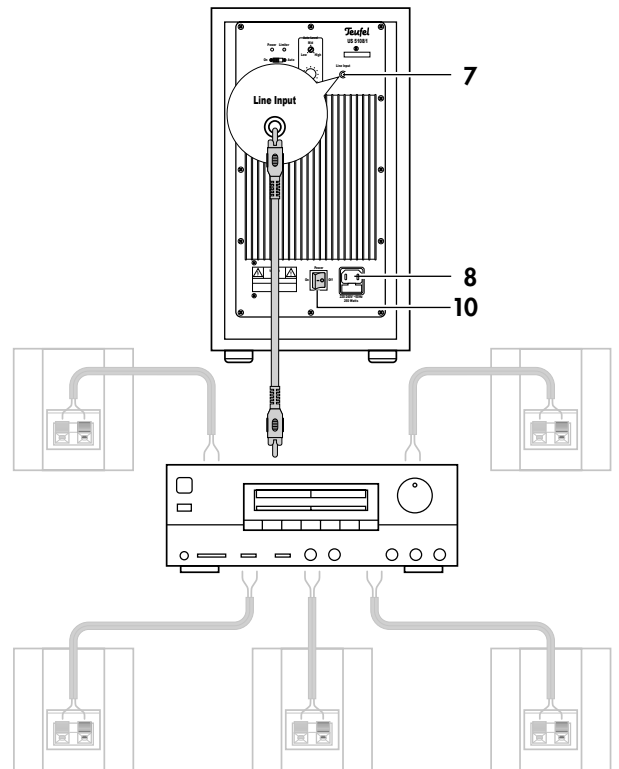

## Troubleshooting

The following instructions should help you to solve problems. If this doesn't work, please contact our hotline (see page 3). Mind the warranty instructions.

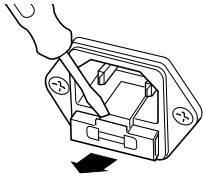
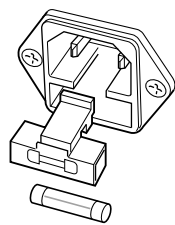
Problem	Possible cause	Solution
The subwoofer doesn't work. The LED <b>3</b> does not illuminate.	The subwoofer is off or doesn't have any power.	Turn on the "Power" switch <b>10</b> ("On I"). Check the mains cord and socket.
	Fuse is defective.	<div style="display: flex; justify-content: space-around;"> <div style="text-align: center;"> <p>1.</p>  </div> <div style="text-align: center;"> <p>2.</p>  </div> </div> <p>Remove the mains cable. Carefully pull out the fuse holder on the mains connection jack.</p> <p>Push the old fuse out downwards. Insert a new fuse (2 A time-lag) and push the holder back.</p>
The subwoofer doesn't work, but the LED <b>3</b> is blue.	The volume has been set too low.	Increase the volume with the "Volume" control <b>6</b> .
The subwoofer hums.	The subwoofer is connected to another circuit than the rest of the system.	Connect the subwoofer and source device to the same electric circuit.
	The buzzing is caused by problems with the power supply.	Buy a line filter and connect both devices to it.
	The buzzing is caused by a multi-way socket.	Use another multi-way socket or plug the subwoofer directly into the wall socket. In the case of two-pin plugs it may help to insert the plug into the socket the other way around.
The subwoofer doesn't turn on.	The sensitivity of the automatic activation has not been set high enough.	Turn the control <b>5</b> "Auto Level" towards "High".
The subwoofer turns on when this is unintended.	The automatic activation has been set too high.	Turn the control <b>5</b> "Auto Level" towards "Low".

## Care and cleaning

Clean the subwoofer regularly with a soft, damp micro-fiber cloth. In the process, be absolutely sure to observe the following notes:

### **Danger Risk of electric shock!**



In contact with live parts, water can lead to electric shock or short circuit.

- Make sure that no liquid penetrates the unit.
- Disconnect the mains plug before cleaning.

### **Attention Risk of damage!**



Using the wrong cleaning materials may damage the delicate surface of the case.

- If possible use only plain water with no cleaning products. In case of stubborn marks, a mild soap solution may be used.
- In no circumstances should caustic cleaning products, white spirit, thinners, petrol or similar be used for cleaning.



## Protecting the environment

### Disposing of the unit



**Used units must not be disposed of with household waste**

If the unit is no longer operational, every consumer is required by law to dispose of used devices separate from household waste, e. g. at a collection point run by the communal authority

orough. In this way, used devices can be recycled and waste materials disposed of in an environmentally friendly manner.

For this reason, electrical equipment is labelled with the displayed symbol

## Technical data

	US5108/1	US5110/1
Operating voltage:	220–240 V~, 50/60 Hz	220–240 V~, 50/60 Hz
Power consumption	max.	250 watts
	in standby	0.4 watts
Dimensions (W x D x H):	240 mm x 365 mm x 420 mm	240 mm x 410 mm x 490 mm
Net weight:	12.8 kg	17 kg

 This product conforms with Council of the European Union guidelines 2004/108/EC and 2006/95/EC

Technical changes reserved!

# Teufel

For questions, suggestions or criticism please contact our customer service department:

**Lautsprecher Teufel GmbH**  
Gewerbehof Bülowbogen - Aufgang D1  
10783 Berlin (Germany), Bülowstr. 66

Tel.: 00800 200 300 40 (toll-free)  
Fax: +49 (0)30-300 930 930  
[www.teufelaudio.com](http://www.teufelaudio.com)

No liability is accepted for the accuracy of this information. Technical changes, typographical errors and other errors reserved.