

Repair manual



MYND®

Battery replacement

Teufel

Table of contents

About this repair manual.....	3
Validity of the repair manual	3
Original packaging.....	3
Complaint	3
Safety.....	4
Explanation of signs and symbols	4
Explanation of safety instructions and warnings	5
General instructions	5
Safety instructions	6
Before you start	7
How will I know if the battery in the loudspeaker needs replacing?	7
What preparations are needed?	7
Required tools	7
Component overview.....	8
Fitting and removing the battery	9
Removing the cover	9
Removing the baffle.....	10
Battery replacement	11
Installing the baffle	12
Fitting the cover.....	13
Performing a functional test	13
Disposal	14

About this repair manual

Validity of the repair manual

This repair manual applies exclusively to the **MYND®** loudspeaker, hereinafter referred to as the “loudspeaker”.

This repair manual contains important information on repairing the loudspeaker safely.

- ▶ Read the repair manual and all supplied instructions, especially the safety instructions, carefully and completely before using the loudspeaker.
- ▶ Failure to follow the instructions may result in injury or material damage.
- ▶ Repair work, such as changing the battery, may only be carried out by individuals who have the necessary knowledge, skills and tools.
- ▶ Always keep all the instructions ready to hand and pass them on to subsequent owners.

The information in this document is subject to change without notice and does not constitute any obligation on the part of Lautsprecher Teufel GmbH.

No part of this repair manual may be reproduced, transmitted in any form or by any means electronically, mechanically, by photocopying or by recording without the prior written permission of Lautsprecher Teufel GmbH.

© Lautsprecher Teufel GmbH
Teufel MYND® RM EN V1.0 PD

Original packaging

If you wish to make use of your right of return, we must ask you to keep the packaging.

We can only take back products in their original packaging.

Empty cardboard boxes are not available.

Complaint

In the event of a complaint, we absolutely require the following information for processing:



1. Invoice number

- ▶ Please refer to the order confirmation or the proof of purchase (enclosed with the product).

2. Serial number

- ▶ See back or bottom of the product.

Explanation of signs and symbols

	<p>Contains small parts which can be swallowed and cause suffocation.</p> <ul style="list-style-type: none">▶ Not suitable for children under three years of age.
	<p>This symbol indicates that the battery and internal components cannot be serviced by users.</p> <ul style="list-style-type: none">▶ Do not open or dismantle the battery under any circumstances. Opening the battery can cause an electric shock, create a fire hazard or damage the device.▶ All other maintenance work should always be carried out by authorized personnel.

Explanation of safety instructions and warnings

This manual contains instructions and information for your safety and correct operation.

The basic safety instructions thematically summarise all the dangers and safety measures and apply at all times.

In addition, specific information is provided in the form of warnings at the beginning of the relevant chapter in the user manual.

- ▶ Note and follow the safety instructions provided below.
- ▶ Follow all instructions, in order to prevent personal injury and environmental or material damage.

The action-related warnings warn against residual dangers and precede a dangerous action step.

- ▶ Note and follow all warnings from the user manual.
- ▶ Note the explanation of warnings in the user manual.

Handling-related warnings precede handling steps that may result in a hazard.

The warnings are grouped into different risk categories depending on the seriousness of the respective hazard.

The hazard levels with the corresponding signal words are explained below.

WARNING

Possible danger to life or serious injury.

ATTENTION

Possible material damage.

NOTE

Additional information and tips.

General instructions

- ▶ Do not use the product in vehicles or boats.
- ▶ Clean the product only with a clean, dry cloth, note the user manual.
- ▶ Contact the customer service department of Lautsprecher Teufel for any repair and maintenance work.
- ▶ To prevent discolouration of the surface, stick felt gliders under the rubber feet of the product or place a rug underneath on parquet flooring, painted wood and similar surfaces.
- ▶ Note the splash protection classes in the user manual.

Safety instructions

Danger to life for children from suffocation!

Unsupervised children could swallow small parts of the product, accessories or packaging material.

The product is not a toy.

- ▶ Do not allow children to play with the product, accessories or packaging material.
- ▶ Do not allow children to carry out repairs, cleaning and maintenance.

Risk of fire or explosion in lithium-ion batteries!

Lithium batteries can catch fire or explode if handled incorrectly.

- ▶ Always replace the battery with original Teufel replacement batteries. Using an unsuitable replacement may cause an explosion.
- ▶ Do not dispose of the battery in a fire or hot oven as this may result in a serious fire or explosion.
- ▶ Never open, dismantle, destroy or mechanically crush, cut, or damage the battery. Avoid impacts and abrupt loads.
- ▶ Never touch, lift or carry the battery by the contacts.

- ▶ Keep the battery away from coins, keys, screws or other metal objects that could form a bridge between the contacts.
- ▶ Do not expose the battery to excessive heat, e.g. direct sunlight or fire, for extended periods of time.
- ▶ Protect the battery from extremely low temperatures.
- ▶ Only charge the battery at an ambient temperature of 10–45°C and in an installed condition.
- ▶ Do not expose the battery to extremely low air pressure, as this may result in the release of hazardous substances.
- ▶ Avoid electrostatic charges and discharges. Do not use synthetic cloths or sponges to clean the battery.

Personal injury hazard and material damage caused by leaking battery acid!

Battery acid leakage can cause skin burns and damage to surfaces.

- ▶ Avoid any contact of battery acid with skin, eyes and mucous membranes.
- ▶ Rinse the affected areas immediately with plenty of clean water in the event of contact with battery acid. Consult a doctor if necessary.

Before you start

How will I know if the battery in the loudspeaker needs replacing?

- ▶ Check the state of the battery in the Teufel Go app.

i NOTE

Even if the battery performance falls below 50%, there is usually no need to replace it.

- ▶ Only replace the battery if the battery life is significantly reduced.

What preparations are needed?

1. Prepare the workplace.
 - ▶ The work area must be dry, well illuminated and free of obstructions.
2. Use a suitable base.
 - ▶ Use a soft, non-slip mat to protect the speaker from damage and prevent slipping.

Required tools

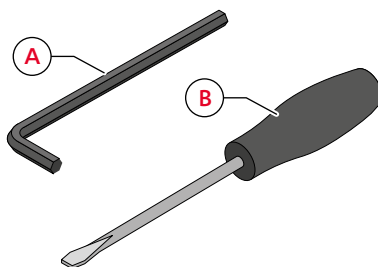

- (A) Hexagon wrench 2.5 mm (minimum length of 50 mm)
- (B) Slotted screwdriver (blade width 3.5 mm)

i NOTE

If the hexagon wrench is too short, not all screws can be loosened.

Component overview

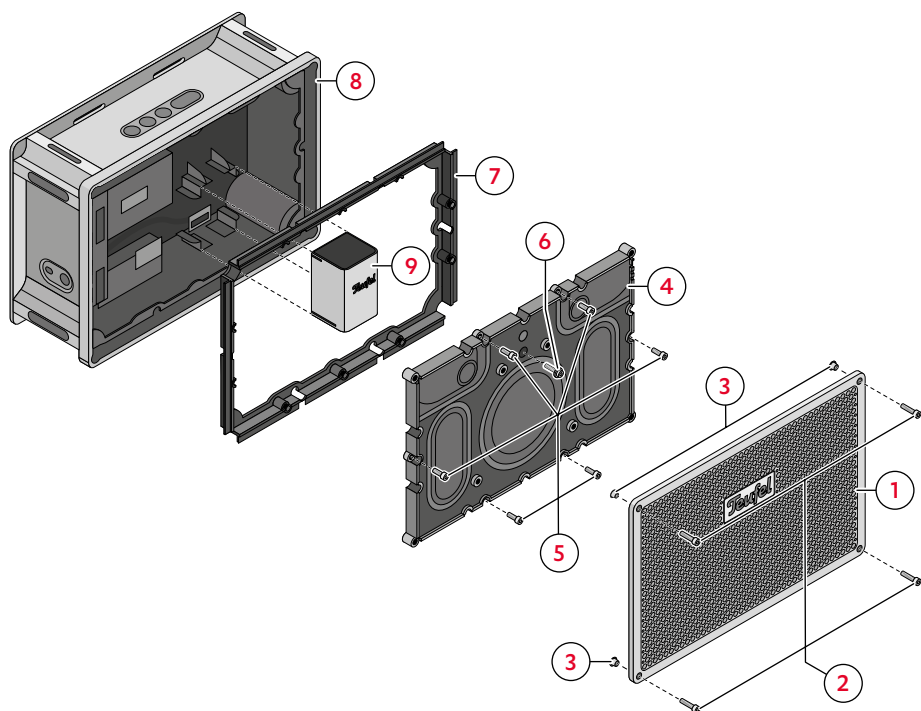

Component overview MYND

- | | |
|----------------------|----------------------|
| (1) Cover | (6) Screw M3x16 (1x) |
| (2) Screw M3x16 (4x) | (7) Seal |
| (3) Screw M3 (4x) | (8) Housing |
| (4) Baffle | (9) Battery |
| (5) Screw M3x9 (6x) | |

Fitting and removing the battery

Removing the cover

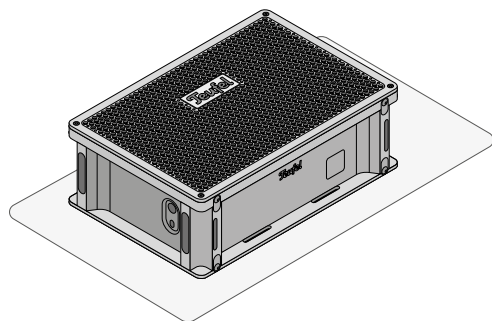

1. Place the loudspeaker on a soft surface.

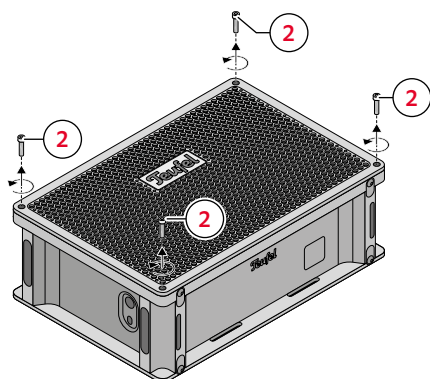

2. Unscrew 4x screw M3x16 (2) and set aside.

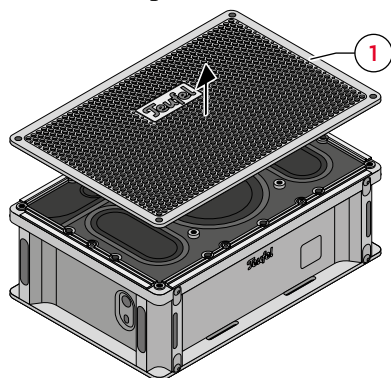

3. Carefully lift the cover (1) at the corners and remove.

✓ The loudspeaker cover is removed.

Removing the baffle

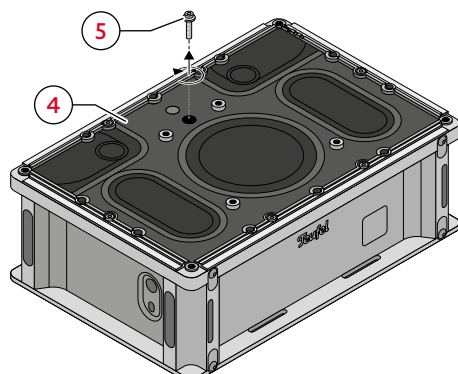

1. Unscrew the screw M3x16 (5) in the centre of the baffle (4).

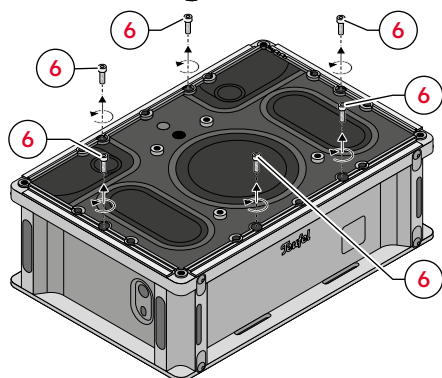

2. Unscrew 6x screw M3x9 (6) and set aside.

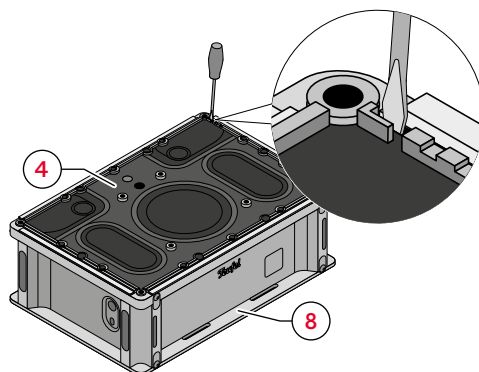

3. Detach the baffle (4) from the housing (8) using a suitable slotted screwdriver.

i NOTE

At the top right, there is a small gap between the baffle (4) and the housing (8).

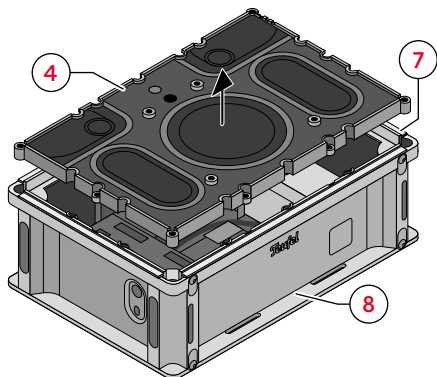

4. Carefully remove the baffle (4) from the housing (8).

Make sure that the seal (7) remains in place on the housing (8).

- If necessary, place the seal (7) back on the housing (8).

✓ The baffle is removed.

Battery replacement

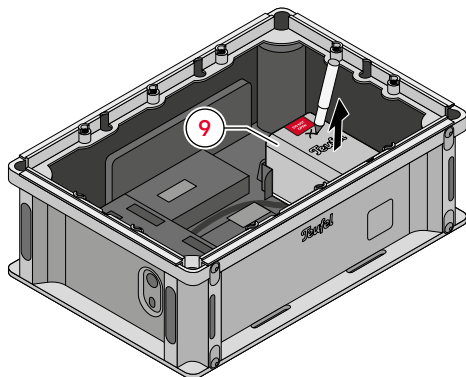

1. Pull the battery (9) upwards in the direction of the arrow and out of the guide rails.

i NOTE

Mark the old battery (e.g. with a permanent marker) to avoid confusion with the new battery.

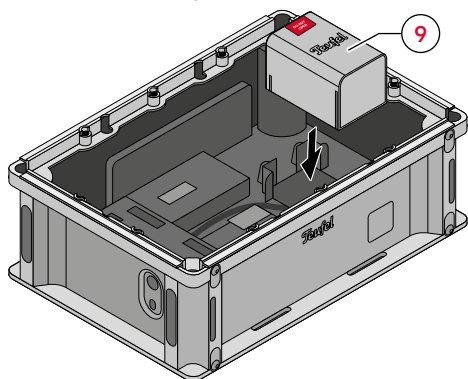

2. Carefully insert the new battery (9) onto the guide rails and slide in all the way.

i NOTE

The battery (9) is held in position by the baffle (4) and only becomes stable when fully assembled.

Installing the baffle

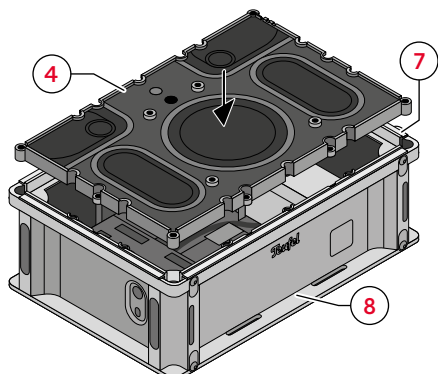

1. Carefully place the baffle (4) in the housing (8).

Make sure that the baffle (4) is seated exactly in the seal (7).

► If necessary, position the seal (7) correctly.

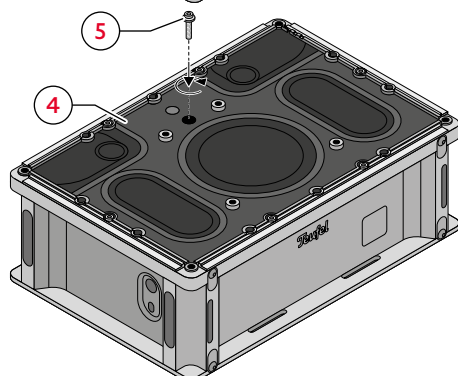

2. Insert the screw M3x16 (5) into the centre of the baffle (4).

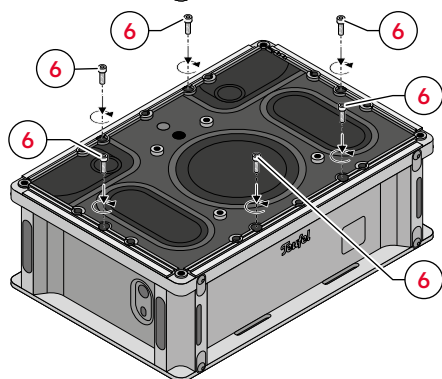

3. Insert 6x screw M3x9 (6).

Fitting the cover

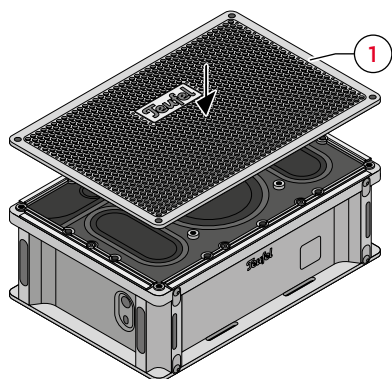

1. Carefully position the cover (1) on the housing and push into place.

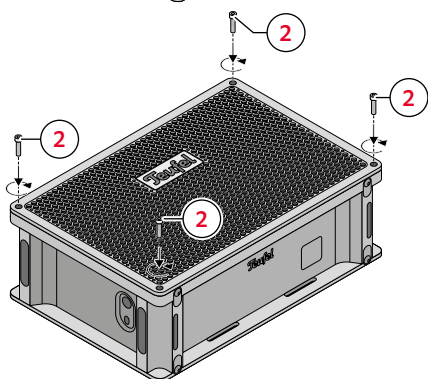

2. Insert 4x screw M3x16 (2).

Performing a functional test

1. Switch on the loudspeaker.
▶ Press and hold the  button for 1.5 seconds.

NOTE

If the speaker does not switch on, charge the battery for a minimum of 15 minutes.

Disposal

Important information according to the Electrical and Electronic Equipment Act (ElektroG)

Electrical and electronic equipment must be recycled separately from household waste in accordance with the applicable statutory provisions.

- ▶ Please refer to the information on the Battery Act (BattG) provided below with regard to the disposal of batteries.
- ▶ Electrical and electronic devices must be recycled and not disposed of in the household waste.

The symbol of a dustbin with a cross through it on electrical and electronic equipment additionally indicates the legal obligation for separate collection.



- ▶ Recycle electrical and electronic equipment at collection points.
- ▶ Do not dispose of electrical and electronic equipment in the household waste.

According to § 17 ElektroG, consumer electronics shops are obliged to take back waste electrical and electronic equipment under certain conditions. Stationary distributors must take back an old electrical appliance of the same type free of charge when selling a new electrical appliance (1:1 take-back). This also applies to home deliveries. These retailers must also take back up to three small used electrical appliances ($\leq 25\text{cm}$) without this being linked to a new purchase (0:1 take-back).

According to the ElektroG, as an online distributor of electrical appliances, we are obliged to take back appliances accordingly, although our obligation to take back 1:1 when delivering a new electrical and electronic appliance is limited to large appliances ($> 50\text{ cm}$) of the same type, due to our product range. We comply with the obligation to take back appliances other than large appliances via our service provider.

- For contact details and drop-off locations, see: www.teufel.de/entsorgung.
- Used electrical appliances can also be returned free of charge to an official drop-off point of the local waste disposal authority.

Note

- ▶ For safety reasons, do not send any lighting devices (such as lamps).
Contact the collection points of the local waste disposal authority to return lighting devices.
- ▶ The end user is responsible for deleting personal data from the used electrical appliances before returning them for disposal.

Our products may contain batteries/rechargeable batteries.

- ▶ Refer to the enclosed product documentation for further information on the type and chemical system of the battery.

Products with battery compartments:

- ▶ Remove the batteries or rechargeable batteries from products with battery compartments yourself and dispose of them properly.

Products with permanently installed batteries:

- ▶ Do not remove the batteries or rechargeable batteries yourself.
- ▶ Contact Teufel.

Important information according to the Battery Act (BattG)

Batteries or rechargeable batteries must be recycled separately from household waste in accordance with the applicable statutory provisions.

- ▶ Please refer to the information on the Battery Act (BattG) provided below with regard to the disposal of batteries.
- ▶ Electrical and electronic devices must be recycled and not disposed of in the household waste.

The symbol of a dustbin with a cross through it on batteries and rechargeable batteries additionally indicates the legal obligation for separate collection.



- ▶ Recycle used batteries and rechargeable batteries at collection points.
- ▶ Do not dispose of used batteries and rechargeable batteries in the household waste.

Used batteries may contain harmful substances which can damage the environment or your health if not stored or disposed of properly. This particularly applies to the incorrect handling of batteries containing lithium. However, batteries also contain important raw materials such as iron, zinc, manganese or nickel and can be recycled. Separate collection enables the recycling of these raw materials and avoids negative impacts of released harmful substances on the environment and human health.

- For contact details and drop-off locations, see: www.teufel.de/entsorgung.
- Batteries and rechargeable batteries can also be returned free of charge to an official drop-off point of the local waste disposal authority.
- ▶ Hand in used batteries which are stocked as new batteries at our Teufel Stores or the mail-order warehouse.
- ▶ Do not send used batteries by post (dangerous goods regulations).

Information on the labelling of rechargeable batteries and avoiding waste

If the legal requirements are met, the following symbols with the following meaning must be used by the manufacturer of the batteries when labelling the batteries:

Hg Battery contains more than 0.0005 percent by mass of mercury

Pb Battery contains more than 0.004 percent by mass of lead

Cd Battery contains more than 0.002 percent by mass of cadmium

- ▶ Use batteries with a long service life or rechargeable batteries, in order to avoid waste.
- Replaceable rechargeable batteries extend the service life of electrical and electronic equipment and enable appliances and rechargeable batteries to be prepared for reuse (e.g. regeneration/replacement of rechargeable batteries).
- ▶ Further information on waste prevention for consumers can be found e.g. in the waste prevention programme of the Federal Government with the participation of the Federal States.

Teufel

If you have any questions, suggestions or criticisms, please contact us at:

Lautsprecher Teufel GmbH

BIKINI Berlin
Budapester Straße 44
10787 Berlin (Germany)

teufelaudio.com

teufel.de

teufel.ch

teufelaudio.at

teufelaudio.nl

teufelaudio.be

teufelaudio.fr

teufelaudio.pl

teufelaudio.it

teufelaudio.es

Tel.:

Germany: +49 (0) 30 217 84 217

Austria: +43 12 05 22 3

Switzerland: +41 43 50 84 08 3

International: 00800 200 300 40 (toll-free)

Online support:

teufelaudio.com/support

teufel.de/support

Contact:

teufelaudio.com/contact

teufel.de/kontakt

All information is provided without guarantee.

Subject to technical changes.

Typographical and other errors excepted.