

Technical Description and Operating Instructions

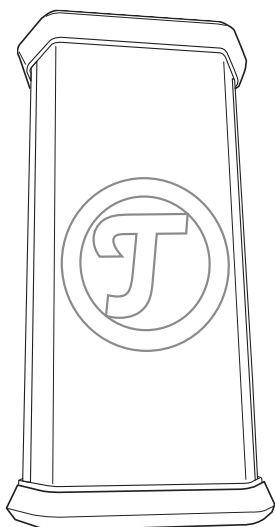

ROCKSTER XS

Mobile Active

Bluetooth Outdoor Speaker

Teufel

Contents

General Notes and Information	2
For Your Safety	5
Control Elements and Connections.....	9
Charging the Rechargeable Battery	11
Operation	12
Protecting the Environment.....	18
Technical Data	18
Declaration of Conformity	19

General Notes and Information

Notice

The information in this document may change without prior notice and in no way constitutes any liability on the part of Lautsprecher Teufel GmbH.

No part of these instructions may be reproduced in any form or be broadcasted in any way electronically, mechanically, by photocopy or recording without the written permission of Lautsprecher Teufel GmbH.

© Lautsprecher Teufel GmbH

Version 1.0

August 2016

Trademarks

® All trademarks are the property of their respective owners.

 **Bluetooth**® Bluetooth® and the Bluetooth symbol are trademarks of Bluetooth SIG, Inc.



aptX® and the aptX symbol are trademarks of CSR plc or affiliated companies and may be registered in several countries.

Original packaging

If you wish to exercise your eight-week right of return, we ask that you be absolutely sure to hold onto the packaging. We can only accept the return of the speakers WITH THE ORIGINAL PACKAGING.

Empty boxes are not available!

Complaints

In case of complaint we will need the following information to process your enquiry:

1. Invoice number

Can be found on the sales slip (enclosed with the product) or on the order confirmation received as a PDF document, e.g. 4322543

2. Serial number or batch number

Located on the back of the device, e.g. serial no.: KB20240129A-123.

Thank-you for your support!

Contact

Please contact our customer service with any questions, suggestions or criticism:

Lautsprecher Teufel GmbH

BIKINI Berlin

Budapester Str. 44

10787 Berlin (Germany)

Phone: 00800 - 200 300 40 (toll-free)

Fax: +49 (0)30 / 300 930 930

E-Mail: service@teufelaudio.com

www.teufelaudio.com

Proper use

The ROCKSTER XS is designed for the playback of music and speech from an external player. The devices can be connected via Bluetooth or AUX cable

The ROCKSTER XS is protected against splash water and dust and may be used outdoors. However, you must protect your ROCKSTER XS against strong and persistent rain.

Only use the ROCKSTER XS as described in this user manual. Any other use will be deemed as not in accordance with the instructions and may lead to physical damage or even injury of persons.

The manufacturer accepts no liability for damage caused by improper use.

The ROCKSTER XS is only intended for private use.



Before operating the ROCKSTER XS, please first read the safety notes and user manual carefully. Only in this way, can you ensure that all functions are used in a safe and reliable manner. Store the user manual in a safe place and also be sure to pass it on to any subsequent owner.

Product contents

1 × ROCKSTER XS

1 × Mains adapter DC 5 V/2.1 A

1 × USB cable (A plug to Micro B plug)

- Check that all items have been delivered and that nothing is damaged. Should the delivery be incomplete or damaged in any way, please contact our customer service department (see “Contact”).
- Do not operate a damaged device.

For Your Safety

Definition of terms

You can find the following signal terms in these instructions:

WARNING

This signal term indicates a moderate risk, which, if not avoided, may result in death or severe injury.

CAUTION

This signal term indicates a low risk, which, if not avoided, may result in minor or moderate injury.

NOTICE

This signal term warns you of potential damage.

Safety Notes

*Read these instructions.
Follow all instructions.*

WARNING

*Risk of electric shock:
Improper electrical installation or excessive mains voltage may result in an electrical shock.*

- Only use attachments/accessories specified by the manufacturer.*
- Use only the supplied mains adapter. Make sure that the mains voltage is correct. More detailed information is available directly on the mains adapter.*

- Check the mains adapter regularly for damage. Never use the mains adapter, if its casing is defective or exhibits other visible damage.
- Only use the mains adapter in indoor areas, do not use it in moist areas and protect it from drops of water or splash water.
- Never open the unit's housing of the mains adapter or the ROCKSTER XS.
- Unplug this mains adapter during lightning storms or when unused for long periods of time.

Risk of explosion:

Batteries (particularly lithium batteries) can explode if used improperly.

- Do not install the ROCKSTER XS near any heat sources such as radiators, heat registers, stoves, or other apparatus (including amplifiers) that produce heat.
Do not expose the ROCKSTER XS to direct sunlight and do not dispose of it in a fire.
- Only use the accessories/tools of outfit (for example. Battery) indicated offering from producer.
- Battery pack shall not be exposed to excessive heat such as sunshine, fire or the like.
- No naked flame sources, such as lighted candles, should be placed on the apparatus.
- Do not use this ROCKSTER XS near water.

- If the housing is defective, stop using the device and store it in an area that is not accessible for children.
- Refer all servicing to qualified service personnel. Servicing is required when the ROCKSTER XS has been damaged in any way, such as power-supply cord or plug is damaged, liquid has been spilled or objects have fallen into the apparatus, the apparatus has been exposed to rain, does not operate normally, or has been dropped.
- Only use the ROCKSTER XS under the following conditions:
 - Ambient temperature: max. 40 °C
 - Maximum height above sea level: 2000 m

Risk of injury:

The ROCKSTER XS permanently generates magnetic fields that may interfere with pacemakers and implanted defibrillators.

- Make sure that the ROCKSTER XS and pacemaker/defibrillator are always at a minimum distance of 10 cm apart.
- Please contact your physician if you have any questions on whether this might affect the operation of your implantable medical device.

⚠ CAUTION

An unsuitable location could lead to damage.

- Do not use the ROCKSTER XS in environments with a risk of explosion.
- Only use Bluetooth in locations where wireless transmission is permitted.



Extended listening at high volumes may lead to hearing loss.

- To avoid damage to health, avoid extended listening at high volumes.
- When the volume is set high, always keep a certain distance from the device and never place your ear directly on the speaker.
- If the signal source device is set to full volume, it may produce very high sound pressure. This may have psychological consequences and also cause physical injury. Children and pets are particularly at risk. Set your signal source device volume control to a low setting before turning on the power.

NOTICE

At a high volume the ROCKSTER XS can vibrate and thereby move on smooth surfaces.

- Place the ROCKSTER XS and any other devices (smartphone, etc) in such a way that they cannot fall due to the vibrations.

Control Elements and Connections

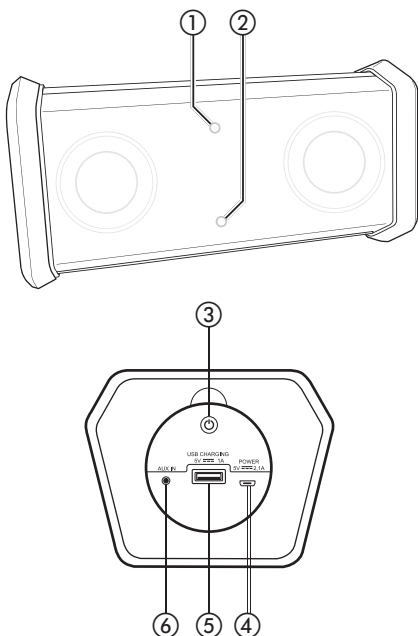

- ① Blue LED (Bluetooth® LED).
- ② Red LED (charging and power-LED).
- ③ On/Off switch.
- ④ USB type B micro jack to charge the rechargeable battery.
- ⑤ USB type A jack (for power supply and to charge an external player, e.g. smartphone).

Notice: This function is only available during operation with internal battery. If the ROCKSTER XS charges itself, the USB type A jack is deactivated.

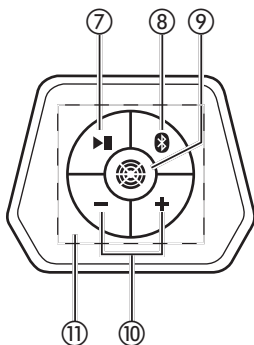

- ⑥ AUX input jack (3.5 mm) for connecting an external player via an audio cable with a 3.5 mm jack plug.
- ⑦ Pause (⏸) and play (▶) (in Bluetooth-mode only).
Wake up from standby.
- ⑧ Activate Bluetooth pairing or disconnect the Bluetooth connection (press and hold for 3 s).
- ⑨ Outdoor mode on/off (higher maximum volume, optimized for outdoor use).
When on, the LED below the button lights up red).
- ⑩ Volume up (+) / volume down (-).
- ⑪ NFC contact zone

Charging the Rechargeable Battery

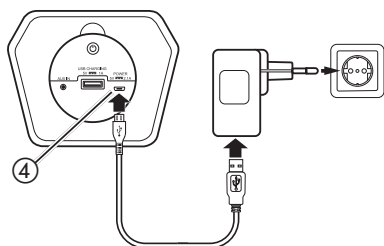

The rechargeable battery in your ROCKSTER XS is charged via the USB cable. Charge it for approx. 3 h before first use.

- To charge the device, connect the USB jack ④ with the USB jack of the enclosed USB charger. Use the enclosed USB cable to do so.
- You can also charge using the USB jack of your PC. However, this will significantly increase the required charging time.
- The red LED ② provides information on the recharging status of the battery:
 - LED pulses: The rechargeable battery is being charged.
 - LED is continuously illuminated: The rechargeable battery has been fully charged.
 - LED blinks: The rechargeable battery has a low charge level.

Operation

Activating/deactivating

- Push the button ③ to switch the device on and off. If the ROCKSTER XS has been switched on, the red LED ② will illuminate. It will turn off when unit shuts down.

Tip: You should always turn off your ROCKSTER XS when it is not in use to save battery power.

Bluetooth® pairing

You can connect compatible devices, such as most smartphones, with your ROCKSTER XS via Bluetooth® (pairing). The audio output of your smartphone is then played back by the ROCKSTER XS.

You can connect 2 external players with the ROCKSTER XS at the same time (see “Simultaneous pairing of two external players” on page 15).

1. Activate the Bluetooth function on your external player (e.g. smartphone).
2. Push and hold the  button ⑧ for approx. 3 seconds.
The blue LED ① will now blink in blue until pairing is complete (no more than 60 seconds).
3. Let your smartphone search for Bluetooth devices (you can find more information in the instruction manual of your smartphone). “Teufel ROCKSTER XS” should also appear in the list of detected devices following the scan.
4. Select “Teufel ROCKSTER XS” from the list of detected devices.
If your external player requires the entry of a PIN code, enter the PIN code “0000” set by factory default.

Pairing is now complete and your ROCKSTER XS is linked to the external player.

The blue LED a is now continuously illuminated and your ROCKSTER XS will play back all sounds that would otherwise be played by your external player.

To terminate the Bluetooth connection, hold the  button ⑧ down for approx. 3 seconds.

Restoring the connection with a paired external player

If your ROCKSTER XS was previously connected to the external player, it is no longer necessary to switch it to pairing mode to connect again. Simply selecting it from the list of paired devices is enough.

NFC

With NFC, you can quickly and comfortably establish a Bluetooth connection between a compatible external player and the ROCKSTER XS.

Notice: Only one external player can be connected via NFC. If you want to connect another external player, please proceed as described in the chapter “Simultaneous pairing of two external players” on page 15.

1. Make sure that the NFC function on your external player has been switched on.

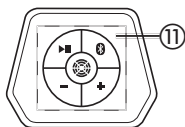

2. Hold your external player close to the control panel of the ROCKSTER XS (NFC contact zone ⑪).

A Bluetooth connection will be established between the two devices after a short time.

Notice: You may be asked to allow the NFC connection. In this case, confirm the request on your external player.

Connection via AUX

As an alternative to Bluetooth®, you can also connect your ROCKSTER XS to the headphone jack of the external player via an AUX cable with 3.5 mm jack plugs, for example.

Select the cable connection if you do not wish or are not allowed to use the Bluetooth function.

Please note:

- With some smartphones, Bluetooth® must be switched off for transmission via AUX.
- A connection via AUX takes precedence over Bluetooth®.
- The Play/Pause button **g** does not work with this connection.
- Due to differing output levels from source devices, the volume may be lower when using AUX as opposed to Bluetooth®.

Other functions

When a call is received

If your ROCKSTER XS is connected with a compatible smartphone via Bluetooth, music playback will be muted when a call is received. You can answer the call with your smartphone and take the phone call as usual. After you hang up, music playback will continue at the previously selected volume.

Automatic deactivation

When the ROCKSTER XS is not in operation and you do not push any button, the ROCKSTER XS will switch to energy-saving mode after approx. 20 minutes (the red LED ② will only be slightly lit).

After another 20 minutes of inactivity and without user input, the ROCKSTER XS will automatically switch off.

Push the Play/Pause button ⑦ to wake it up.

Interruption of connection

The Bluetooth connection will be cut if you are outside of the range of your external player with your ROCKSTER XS. The connection will be re-established automatically when you are back within range.

Simultaneous pairing of two external players

Two external players can be paired with your ROCKSTER XS at the same time. The external player on which playback was last started always has precedence.

1. Pair external player 1 with the ROCKSTER XS.
2. Pair external player 2 with the ROCKSTER XS too.
3. Connect external player 1 again with the ROCKSTER XS (select it from the list of paired devices).

The audio output of your external players is then emitted by the ROCKSTER XS.

If the ROCKSTER XS is connected with 2 external players, the blue LED ① will pulse.

Pairing of a second ROCKSTER XS

“Stereo Connect” via Bluetooth®

You can enjoy your music in stereo with a second ROCKSTER XS. For this, you must first connect the two ROCKSTER XS with one another.

Requirements:

- Before you activate the “Stereo Connect” mode the ROCKSTER XS no. 1 must be connected to the external player via Bluetooth® or AUX cable.
- ROCKSTER XS no. 2 may not be connected via Bluetooth® and the AUX input jack ⑥ must be unplugged.

Using “Stereo Connect”

1. Connect the ROCKSTER XS no. 1 with the external player via Bluetooth® or AUX.

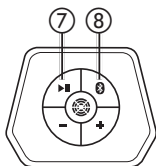

ROCKSTER XS no. 1

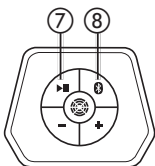

ROCKSTER XS no. 2

2. On both ROCKSTER XS hold the Bluetooth button (8) down at the same time and press the Play/Pause button (7) for approx. 3 seconds.

If the two ROCKSTER XS are connected in “Stereo Connect” mode, the blue LED (1) of ROCKSTER XS no. 1 will pulse. The blue LED of ROCKSTER XS no. 2 will be slightly lit. ROCKSTER XS no. 2 will then immediately play back the right stereo channel. ROCKSTER XS no. 1 will play back the left stereo channel.

To terminate the pairing of the two ROCKSTER XS and to stop the “Stereo Connect” mode, briefly push the Bluetooth button (8) or switch the ROCKSTER XS off.

Notice:

- In “Stereo Connect” mode it is not possible to connect two external players simultaneously
- Depending on the type and location of installation, the range while in Stereo Connect Mode may vary. Place both ROCKSTER XS so that they have a direct “line of sight” contact and are no more than 1 m apart.

Cleaning & Maintenance

NOTICE

Risk of damage: Liquid can destroy the electronics in your ROCKSTER XS! Using unsuitable cleaning agents may damage the housing.

- *Make sure that no liquids penetrate the device.*
- *Do not in any case use solvents or abrasive cleaners.*

To clean your ROCKSTER XS

- Turn the ROCKSTER XS off and remove all cable connections before you start cleaning.
- Ideally, you can remove any dust or light dirt with a dry microfibre cloth.
- You can wipe off more stubborn dirt with a cloth which has been slightly dampened with water. Make sure that no water can penetrate into the housing case.
- Then immediately wipe the damp surfaces off with a soft cloth without applying pressure.

Protecting the Environment



Old devices must not be disposed of with household waste!

If the device is no longer operational, every consumer is required by law to dispose of old devices separately from household waste, e.g. at a collection point run by the communal authority/borough. This ensures that old devices are recycled in a professional manner and also rules out negative consequences for the environment.

For this reason, electrical equipment is marked with the following symbol.



Batteries and rechargeable batteries do not belong in the household waste!

Every consumer is required by law to bring all batteries and rechargeable batteries, regardless whether they contain harmful substances*) or not, to a collection point run by the communal authority or borough or to a retailer, so that they can be disposed of in an environmentally friendly manner.

Please only turn in batteries and rechargeable batteries which are empty!

*) labelled with: Cd = cadmium, Hg = mercury, Pb = lead

Technical Data

- Power supply: 5 V DC, 2.1 A max
- Battery: Li-Ion 7.4 V/4400 mAh
- Dimensions (L×W×H): 176 x 87 x 70 mm

You can find further technical data on our website. Technical changes reserved!



EG-Konformitätserklärung EU-Declaration of Conformity

Hiermit bestätigen wir, dass das nachfolgend bezeichnete Gerät den angegebenen-Richtlinien entspricht.

We herewith confirm that the appliance as detailed below complies with the mentioned directives.

Artikelbezeichnung: ROCKSTER XS

Article description:

Firmenanschrift: Lautsprecher Teufel GmbH
Company address: Budapester Straße 44
D-10787 Berlin

Einschlägige EG-Richtlinien / Governing EU-directives / Directives CE concernées :

- 1. Elektromagnetische Verträglichkeit (EMV)
Electromagnetic compatibility (EMC)
2004/108/EC
- 2. Niederspannungs-Richtlinie
Low-voltage directive
2006/95/EC
- 3. Funkanlagen und Telekommunikationsendeinrichtungen
Radio and Telecommunication Terminal Equipment
R&TTE 1999/5/EC
- 4. Ökodesign – Richtlinie
Energy – Using – Product – Directive (EuP)
2009/125/EEC
- 5. Richtlinie zur Beschränkung der Verwendung
bestimmter gefährlicher Stoffe in Elektro- und Elektronikgeräten
(Rohs- Richtlinie 2011/65/EC)

Harmonisierte EN-Normen / Harmonised EN-Standards

Der Artikel entspricht folgenden, zur Erlangung des CE-Zeichens erforderlichen Normen:

The article complies with the standards as mentioned below which are necessary to obtain the CE-symbol:

DIN EN 55013:2013
DIN EN 55020:2012
DIN EN 61000-3-2:2010
DIN EN 61000-3-3:2014
DIN EN 60065:2011
DIN EN 62133: 2013
DIN EN 62321: 2009
ETSI EN 301489-1
ETSI EN 300328 V 1.8.1:
Verordnung 1275/2008
Verordnung 0125/2009

Ausstellungsdatum / Date of issue: 09. Oktober 2015

Teufel

Please contact our customer service with any questions, suggestions or criticism:

Lautsprecher Teufel GmbH

BIKINI Berlin

Budapester Str. 44

10787 Berlin (Germany)

Phone: 00800 - 200 300 40 (toll-free)

Fax: +49 (0)30 - 300 930 930

www.teufelaudio.com

No responsibility is assumed for the correctness of this information.

Technical changes, typographical errors and other errors reserved.

Manual No. 93462_GB_20160809