

Technical Description and User Manual

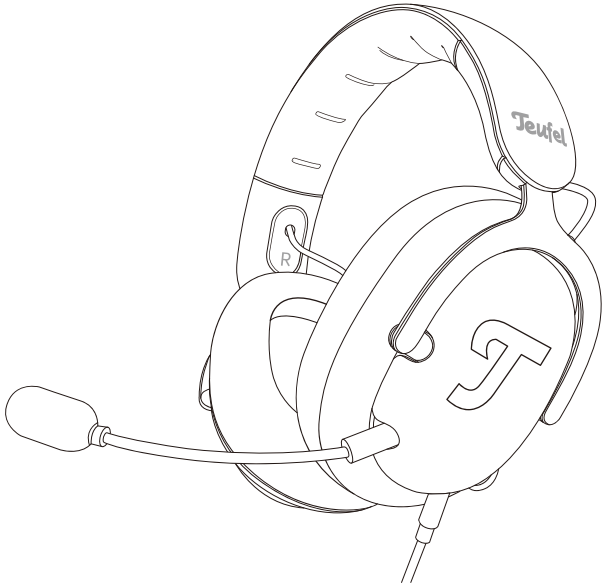

ZOLA® Gaming Headset



Download ZOLA Software:
<https://teufelaudio.com/tac-zola>



Table of contents

Introduction	3
General Information	4
Notice	4
Right of Return	4
Complaints	4
For Your Safety	5
Proper Use.....	5
Trademarks.....	6
1. What's in the box.....	7
2. Product overview.....	8
2.1 Gaming Headset.....	8
3. Getting started	9
3.1 Assembling the Headset.....	9
3.2 Connecting.....	11
3.3 Handling.....	11
4. Using the Headset.....	12
4.1 Controlling.....	12
4.2 Other functions.....	13
5. Care and maintenance	14
6. Troubleshooting	15
7. Technical Data	16
8. Declaration Of Conformity	17

Introduction

Thank you for purchasing the ZOLA Gaming Headset which is designed to bring an extraordinary sound and voice experience for gamers and for anyone looking to equipping their home office. Please read this user manual before using the headset for the first time, it will provide you with useful information and help you get started.

General Information

Notice

The information in this document is subject to change without prior notice and in no way constitutes any liability on the part of Lautsprecher Teufel GmbH.

No part of this user manual may be reproduced in any form or be broadcasted in any way electronically, mechanically, by photocopying or recording without the written permission of Lautsprecher Teufel GmbH.

© Lautsprecher Teufel GmbH

Version 1.0

June 2022

Right of Return

If you wish to exercise your right of return, we ask that you make sure that you hold onto the original packaging. We can only accept the return of headphones with the original packaging. Headset returned without the original packaging will not be accepted.

Complaints

In the event of a complaint, the invoice number is required in order for your complaint to be processed. The invoice number can be found on the sales slip (enclosed with the product) or on the order confirmation PDF document.

Thank you for your support!

For Your Safety

Proper Use

The “ZOLA Gaming Headset” is designed for the playback of audio and voice signals, which are transmitted with the help of the enclosed cable. Only use the headset as described in this user manual. Any other use will be deemed as not in accordance with the instructions and may lead to damage to property or even persons. The manufacturer accepts no liability for damage caused by improper use. The headset are suitable for use at home.



Before operating the headset, please first read the safety notes and user manual carefully. This is the only way to use all functions safely and reliably. Store the user manual in a safe place and also be sure to pass it on to any subsequent owner.

Trademarks

© All trademarks are the property of their respective owners.

1. What's in the box

Unpack the box carefully and ensure that the following parts are included. If any part is damaged or missing, do not use it and contact your retailer or customer service representative.



Gaming Headset

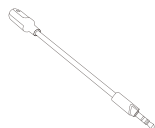

1 x Mic Arm



1 x Windscreen



1 pair of Top Covers



1 pair of Cushions

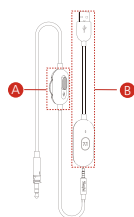

- A. 1 x Audio Cable & Remote (A)
- B. 1 x USB Dongle (B)

2. Product overview

2.1 Gaming Headset

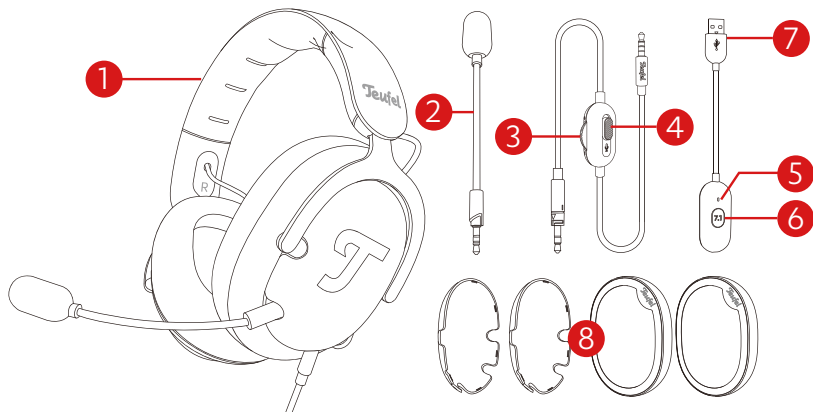

The “ZOLA Gaming Headset” consists of the following elements:

- 1 Gaming Headset
- 2 Mic Arm
- 3 Analog Volume Wheel
- 4 Microphone Mute Switch
- 5 LED Indicator
- 6 Surround Button
- 7 Dongle
- 8 Top Cover & Cushions

Note: Accessories are located underneath the headset.

3. Getting started

3.1 Assembling the Headset

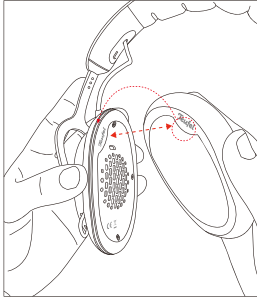

Insert the top side of the cushion flap into the headphone gap so that the Teufel logos are aligned.

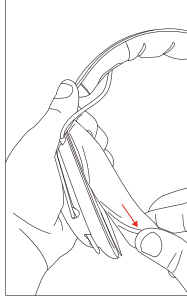

Grip the already inserted top part of the cushion while stretching and inserting the bottom parts.

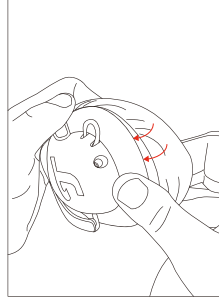

Rotate the headset and insert the remaining parts.

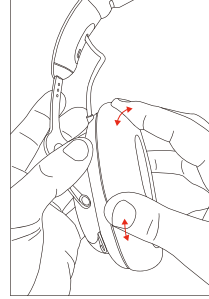

Gently shuffle the cushion so that all parts fall in place.

To remove the cushion, hold the headset firmly and pull the cushion off at an angle.

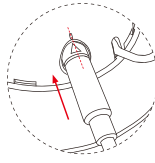
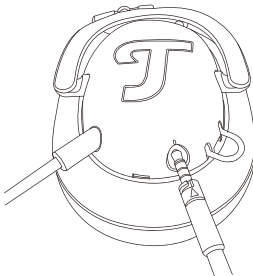

1

Insert the plug with triangle on top in alignment with the mark on the cup. Keep alignment of both markings.

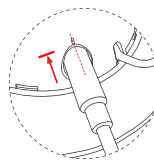

2

Insert until it is fully attached.

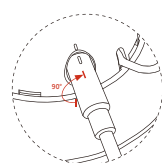

3

Rotate the plug 90° clockwise until the line marking of the plug is aligned with marking at the cup. The plug is now fixated.

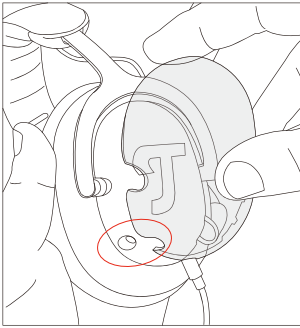

Align the top cover side openings with the headset.

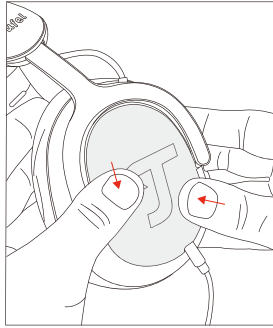

Once placed properly on the headset push the top cover in until you hear a click.

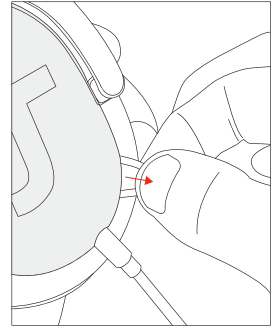

Pull the braided cord outwards if you wish to remove the top cover.

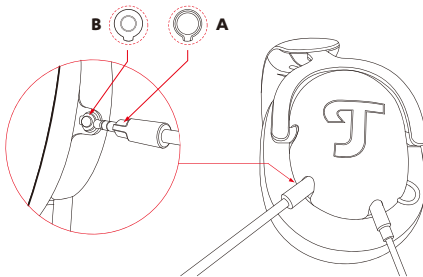

Insert the plug with raised part in alignment with the notch in the microphone plug.

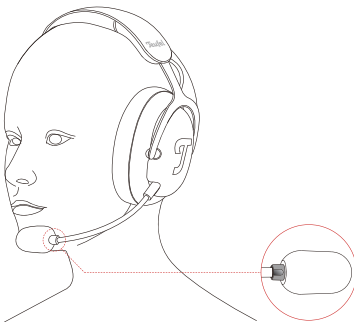

There is a little groove with a glossy finish on the inside of the boom arm head. This needs to point in the direction of the mouth and be about 2-4cm away to get an optimal signal to noise ratio.

3.2 Connecting

Use the enclosed Dongle to connect the headset to a USB port on your PC to enable Surround Sound. Or connect the 3.5 mm plug of the headset to gaming controller or smartphone.

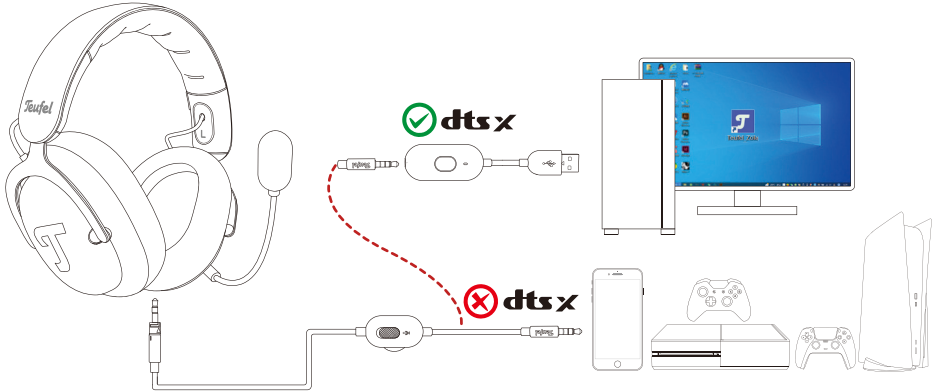

3.3 Handling

Put your headset on so that both ears are firmly covered. If necessary, adjust the headband length to your head size.

4. Using the Headset

4.1 Controlling

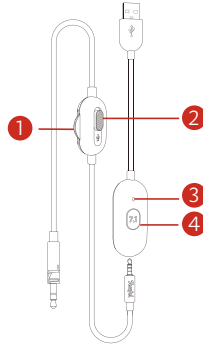

- 1 Analog Volume Wheel: Rotate the wheel upwards to increase the volume or downwards to decrease the volume.
- 2 Microphone Mute Switch: Push the button up to mute the microphone or down to unmute the microphone.
- 3 LED Indicator: Lights up, when the surround dongle is turned on.
- 4 Dongle: Press the button to enable/disable surround sound.

4.2 Other functions

1. Lighting

The LED on USB dongle will indicate whether you enable/disable surround sound.

2. Detachable USB Soundcard Dongle

The headset has a detachable USB soundcard dongle, you can use it for PC gaming.

3. Teufel Audio Center

When you use the ZOLA on your Windows PC, you can access the Teufel Audio Center for ZOLA features. You can configure the sound, select the microphone level, activate the surround presets, customize your own surround effect or add a voice effect.

For more information on the settings and functions of Teufel Audio Center for ZOLA, please see the link below:
<https://teufelaudio.com/tac-zola>

5. Care and maintenance

The headset may require periodic cleaning.

Component	Cleaning procedure
Cushions, Windscreen & Top Covers	Clean the cushion and top cover with mild detergent. Remove the windscreen from the microphone and wash with mild detergent and water. Note: Make sure you thoroughly rinse and dry the windscreen before re-attaching it to the microphone. Do not use force when removing and installing the windscreen.
Headband	Clean only with a dry, soft cotton swab or equivalent. Note: Never use aggressive cleaning agents as they may damage the sensitive surface.

Environmental Conditions

The operating temperature range must be between 0°C and 45°C.

The storage temperature range must be between -20°C and 65°C.

6. Troubleshooting

If you experience problems with your headset, see the table below to identify symptoms and solutions to common problems. If you are still

unable to resolve your issue, contact Teufel customer service.

Problem	Possible cause	Solution
No audio playback.	The USB or 3.5 mm plug cable is not properly connected.	Properly connect the USB or 3.5 mm plug cable with devices.
	Volume has been set too low.	Increase the volume on the PC, gaming controller and/or headset.
No voice reproduction.	The microphone switch is in the wrong position.	Set the microphone switch at the  position to switch on the microphone.
Bad intelligibility of speech.	Directional mic is not facing towards the user's mouth.	Use the glossy groove on the mic arm to adjust the front of the microphone towards the mouth.
Weak bass.	Cushions were not attached correctly.	Check if the rubber lip is correctly slid into the recess and does not throw up wrinkles. The cushion needs to sit firmly in place so that the sealing works correctly.

7. Technical Data

Driver Size:	2 x 40 mm full range
Max. power:	50 mW
Impedance:	32 Ω +/-15% @ 1 kHz; 1 mW input power
Microphone sensitivity:	-45 dB (+/- 3.0 dB) @ 94 dB SPL, 1 kHz
Frequency response:	20 Hz – 20 kHz
Dongle input voltage:	5 V DC, 0.5 A

You can find further technical data on our website.

Technical changes reserved!

8. Declaration Of Conformity

 This appliance fulfils the applicable European and national guidelines. This is confirmed by the CE mark. Below the links for downloading the CE conformity:

www.teufel.de/konformtaetserklaerungen

www.teufelaudio.com/declaration-of-conformity

Teufel

Please contact our customer service department with any questions, suggestions, or complaints:

Adresse anpassen:

Lautsprecher Teufel GmbH
Bikini Berlin
Budapester Str. 44 add line feed
10787 Berlin (Germany)

www.teufelaudio.com
www.teufel.de
www.teufel.ch
www.teufelaudio.at
www.teufelaudio.nl
www.teufelaudio.be
www.teufelaudio.fr
www.teufelaudio.pl
www.teufelaudio.it
www.teufelaudio.es

Telefon:

Deutschland: +49 (0)30 217 84 217
Österreich: +43 12 05 22 3
Schweiz: +41 43 50 84 08 3
International: 0800 400 300 20
Fax: +49 (0) 30 / 300 930 930
Online-Support:
www.teufelaudio.com/service
www.teufel.de/service
Kontaktformular:
www.teufel.de/kontakt
Contact:
www.teufelaudio.com/contact

No responsibility is assumed for the correctness of this information.
Technical changes, typographical errors and other errors reserved.